

PLAYGROUND SPIELPLATZ

PLAC ZABAW AIRE DE JEUX

(491 x 507 x h314cm)

003_08280_12022024

GX_SUNSHINE V2

INSTALLATION INSTRUCTIONS
MONTAGEANLEITUNG

INSTRUKCJA MONTAŻU
GUIDE D'INSTALLATION

Warranty period - 2 years from purchase date

Garantiezeit - 2 Jahre ab Kaufdatum

Okres gwarancji - 2 lata od momentu zakupu towaru

Période de garantie - 2 ans à compter de l'achat

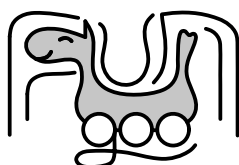

fungoo®

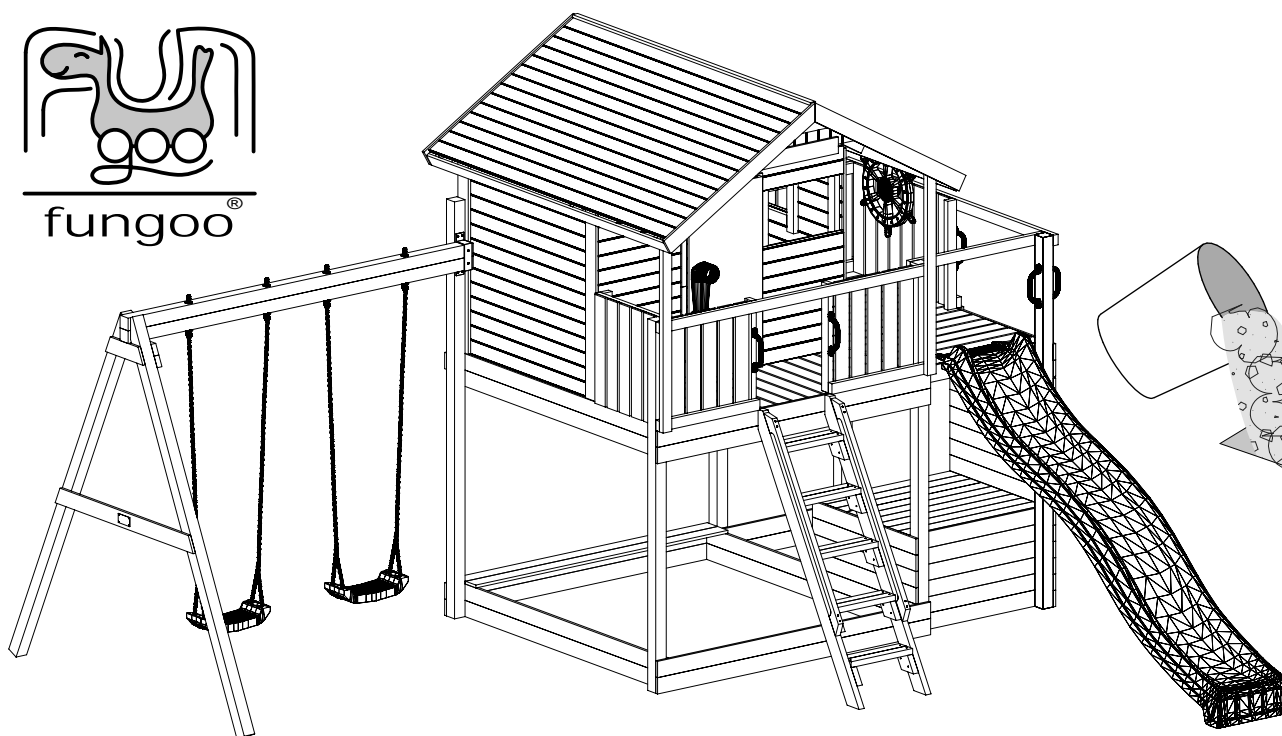

EN - 71

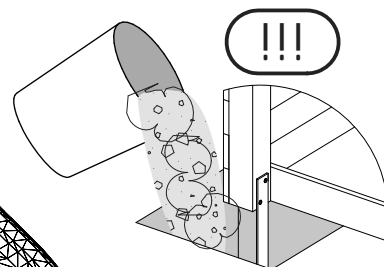

WARNINGS!

Only for home use.

Dedicated for external use only.

Not suitable for children under 3 years old.

Risk of falling down and/or hitting.

Maximum user weight is up to 50 kg.

Maximum number of users staying on the
playground at the same time: 13.

OSTRZEŻENIA !

Tylko do użytku domowego .

Przeznaczony do użytku na zewnątrz .

Nie przeznaczony dla dzieci poniżej 3 roku życia .

Niebezpieczeństwo upadku i /lub uderzenia .

Maksymalna waga użytkownika to 50 kg .

Maksymalna liczba użytkowników przebywających
na placu zabaw w tym samym czasie: 13.

ACHTUNG!

Nur für den privaten , häuslichen Bereich .

Ausschließlich für die Verwendung im Freien .

Nicht geeignet für Kinder unter 3 Jahren .

Stolper- und / oder Sturzgefahr

Höchstgewicht pro Einzelkind beträgt 50 kg

Der Aufenthalt auf diesem Spielturm ist max. : 13.

Kindern gleichzeitig erlaubt.

AVERTISSEMENT!

Aire exclusivement destinée à un usage privé .

Aire exclusivement destinée à un usage en extérieur .

Prévue pour les enfants de plus de 3 ans .

Danger de chute ou de choc.

Poids maximal d'un utilisateur : 50 kg .

Nombre maximal d'utilisateurs présents en
même temps sur la même aire de jeux : 13.

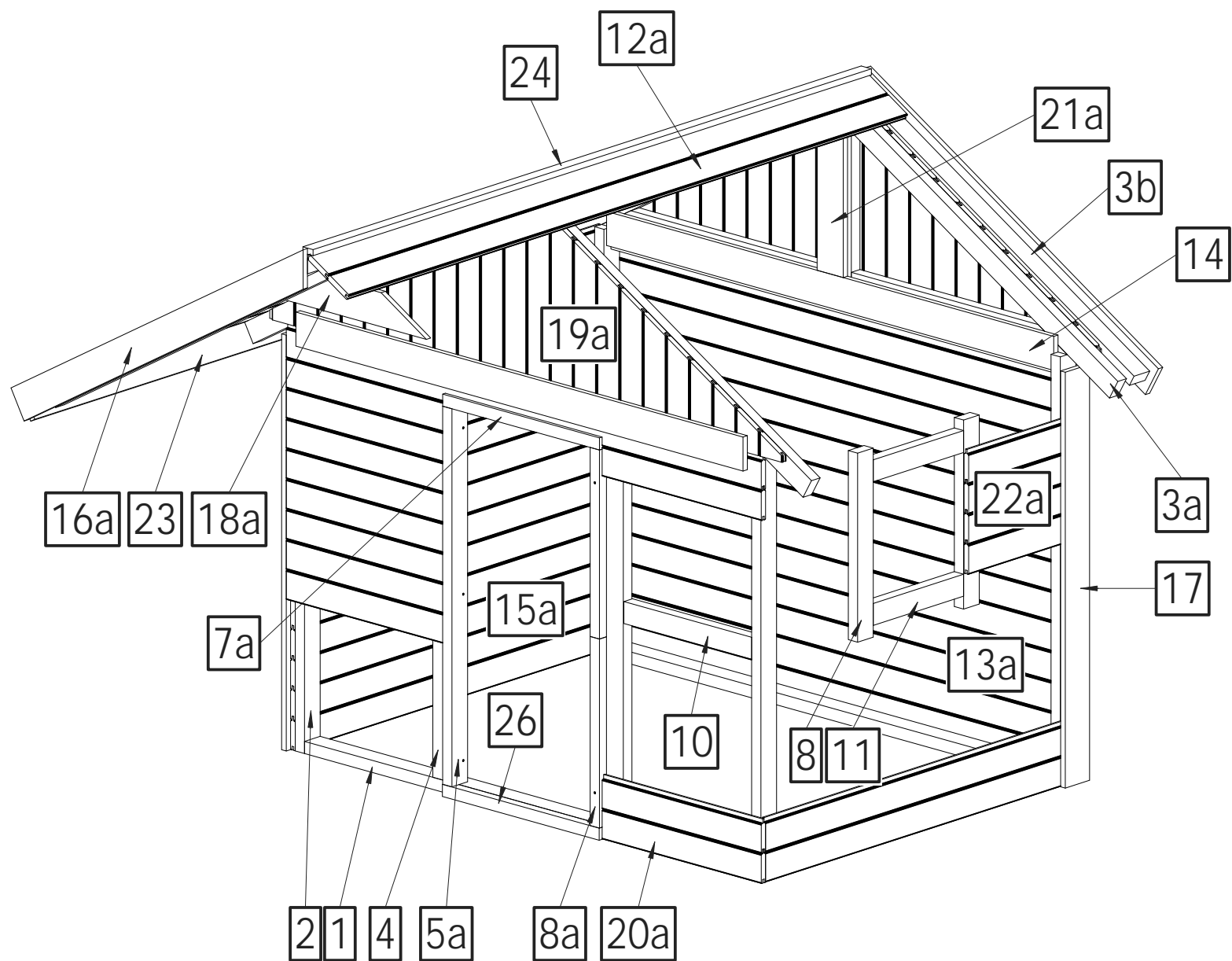

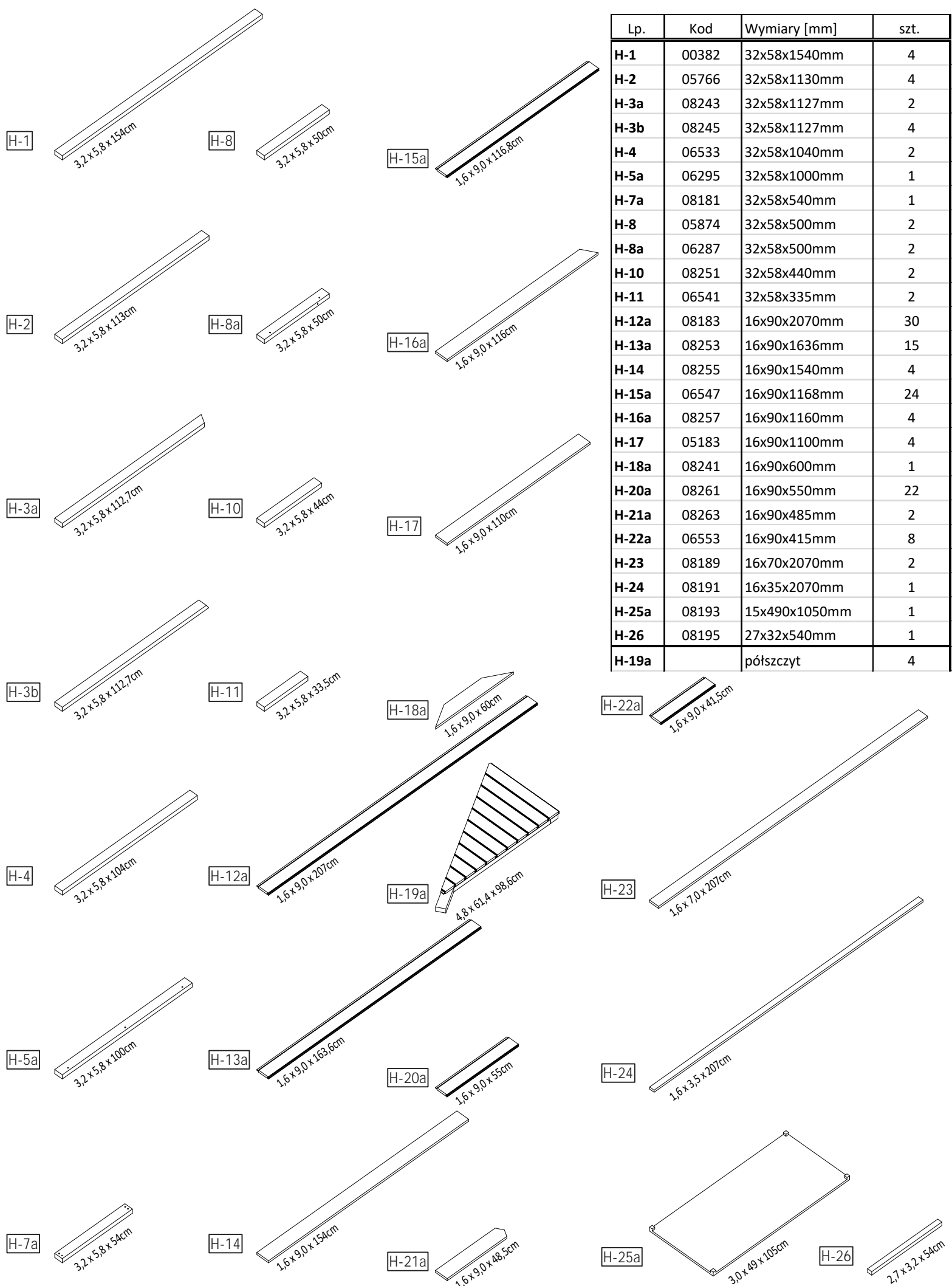

W80 x265

+3 Gratis



W40 x1032

+39 Gratis



W30 x2

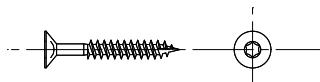

W20 x4

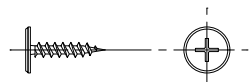

T80 x77

+2 Gratis

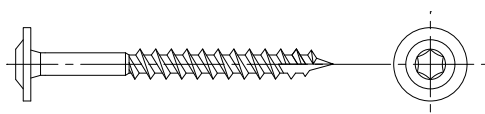

T60 x50



S50 x8

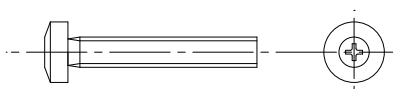

S30 x12

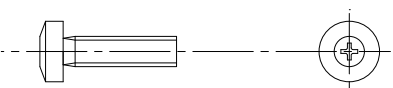

L11 x20

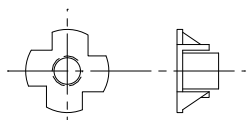

P17 x26

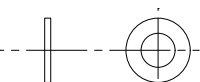

P15 x12

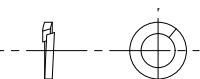

M12 x4

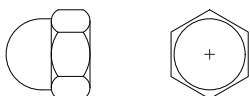

OS1 x75

+6 Gratis



Ø3
00239
x1

Ø5,5
01372
x1

Ø10
00188
x1

PH3
00068
x1

PZ2
00241
x1

TX25
00190
x1

TX30
00316
x1

TX40
00242
x1

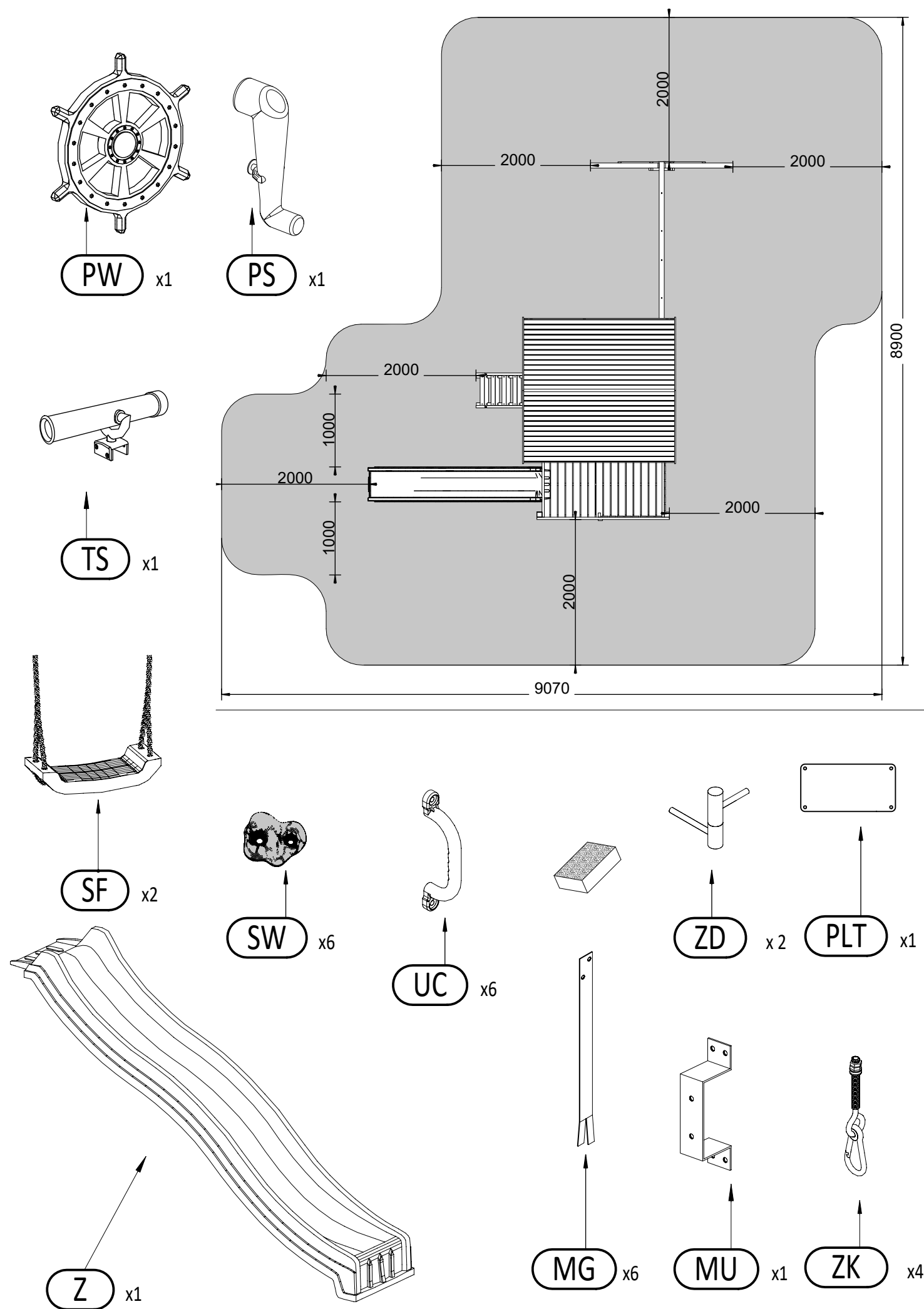

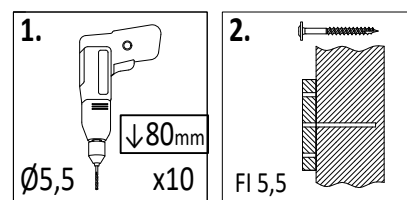
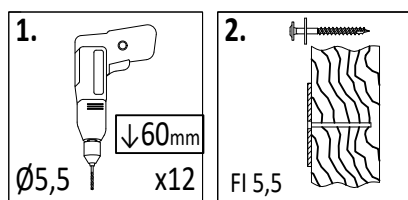
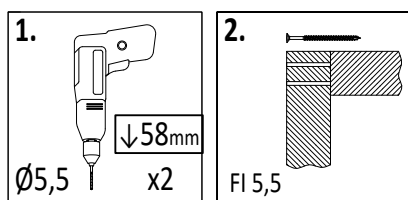
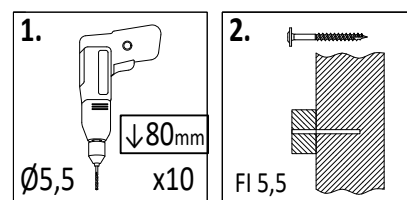
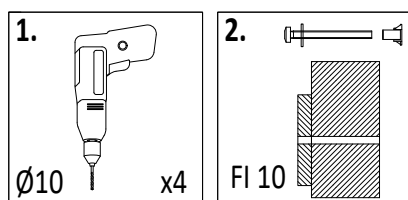
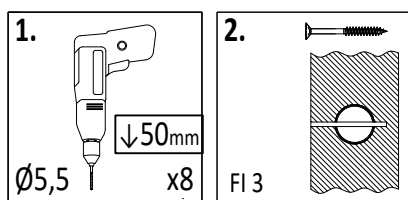
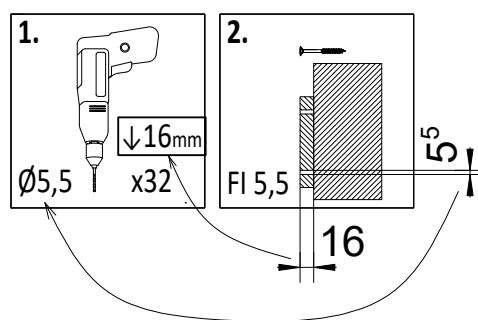
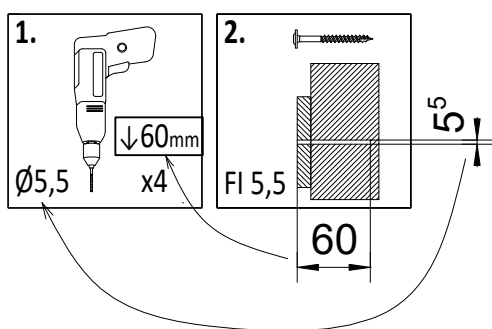
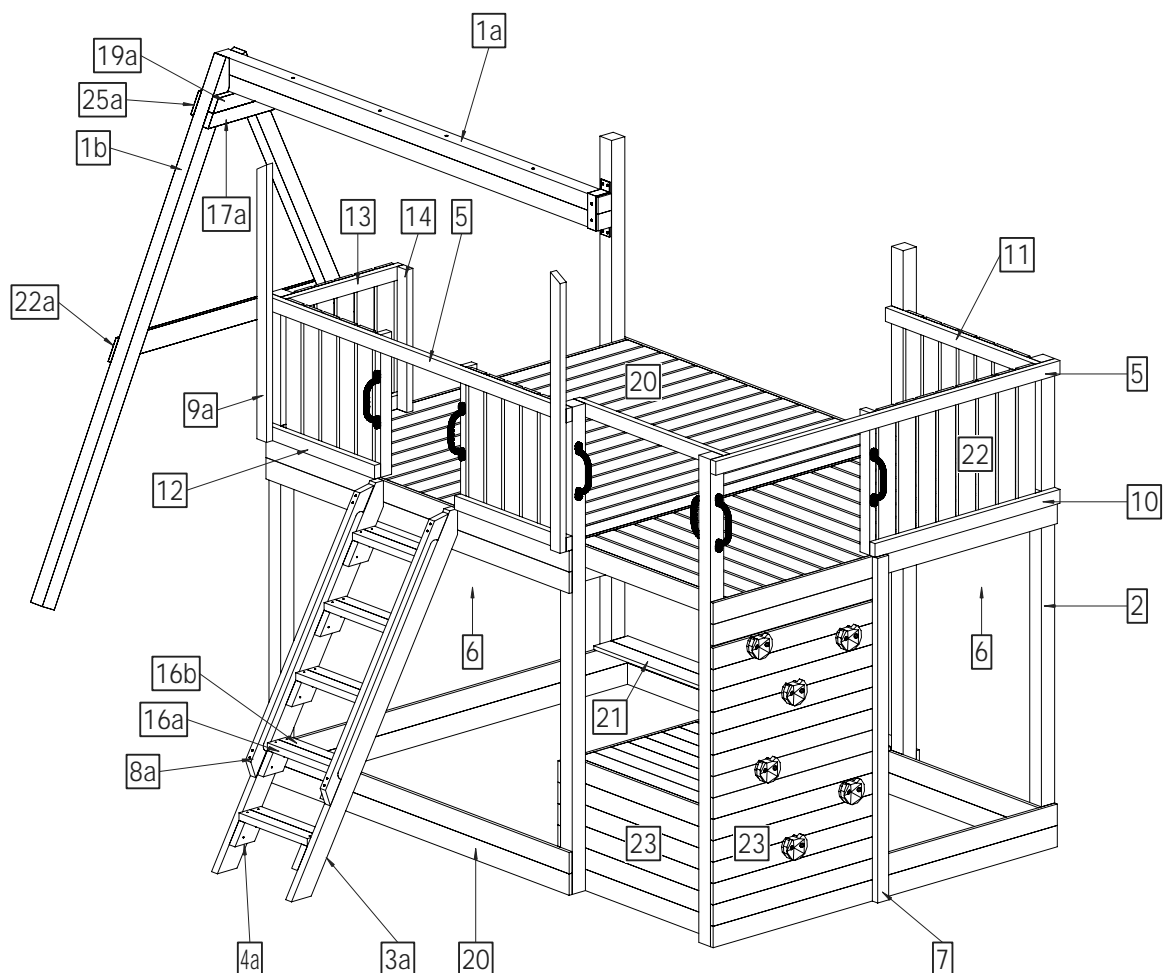

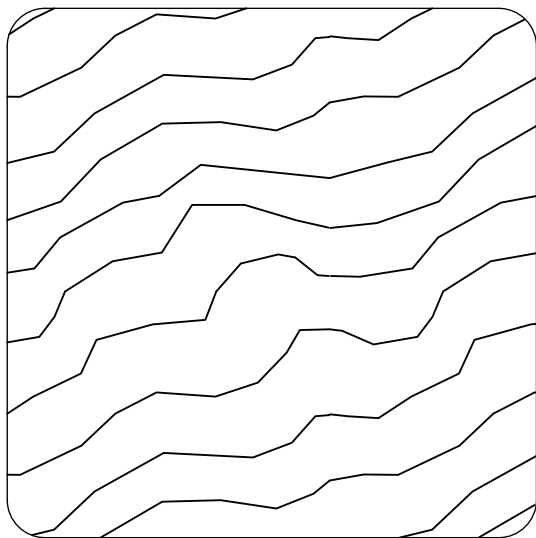

7,0 x 7,0 cm

Lp.	Kod	Wymiary [mm]	szt.
P-1	04451	70x70x2300mm	2
P-1a	04448	70x70x2300mm	2
P-1b	04453	70x70x2300mm	2
P-2	05854	70x70x2050mm	4

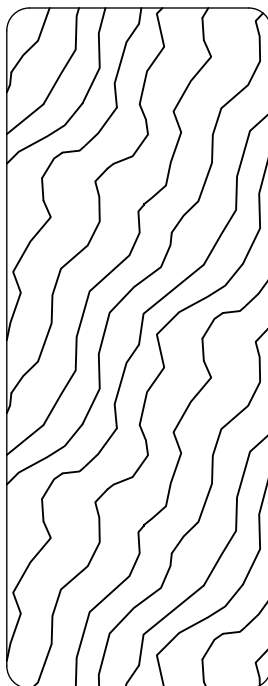

3,5 x 9,0 cm

Lp.	Kod	Wymiary [mm]	szt.
P-3a	06707	35x90x1695mm	2
P-4a	00730	35x90x156mm	10

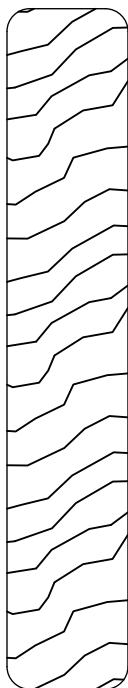

1,6 x 9,0 cm

Lp.	Kod	Wymiary [mm]	szt.
P-20	06567	16x90x1820mm	35
P-21	08217	16x90x1680mm	2
P-22a	03920	16x90x1200mm	1
P-23	05181	16x90x900mm	52
P-24	04625	16x90x600mm	30 + 7
P-25a	04469	16x90x325mm	1

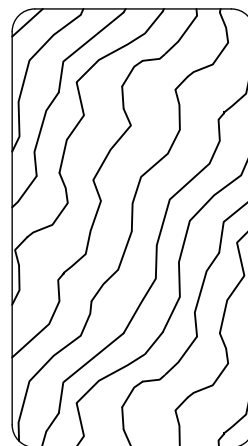

3,2 x 5,8 cm

Lp.	Kod	Wymiary [mm]	szt.
P-5	06427	32x58x1820mm	2
P-6	00263	32x58x1648mm	7
P-7	05836	32x58x1450mm	1
P-8a	01412	32x58x1250mm	2
P-9a	08197	32x58x1168mm	2
P-10	08199	32x58x980mm	1
P-11	05725	32x58x900mm	3 + 1
P-12	05826	32x58x670mm	2
P-13	05327	32x58x620mm	2
P-14	03100	32x58x600mm	4
P-15	08251	32x58x440mm	4
P-16a	00350	32x58x410mm	5
P-16b	00340	32x58x410mm	5
P-17a	04461	32x58x350mm	1
P-18	06541	32x58x335mm	2
P-19a	04463	32x58x296mm	1

P-1

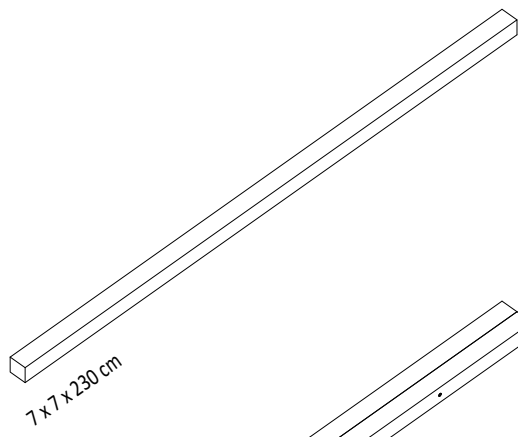

P-1a

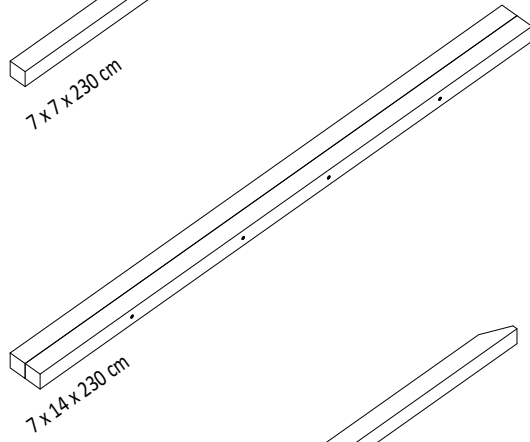

P-1b

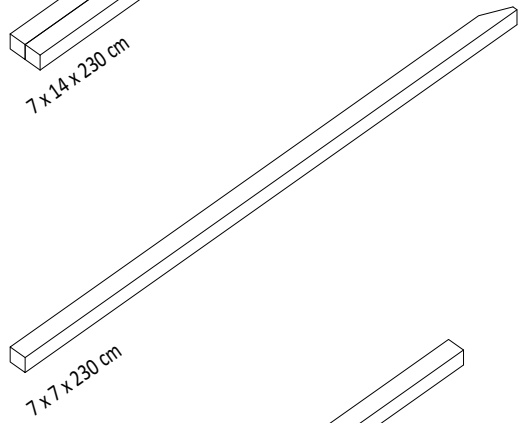

P-2

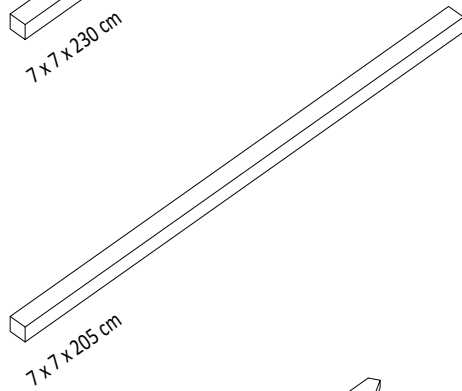

P-3a

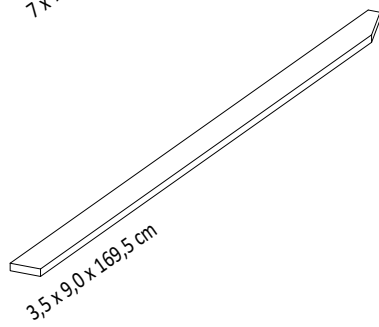

P-4a

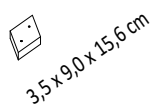

P-5

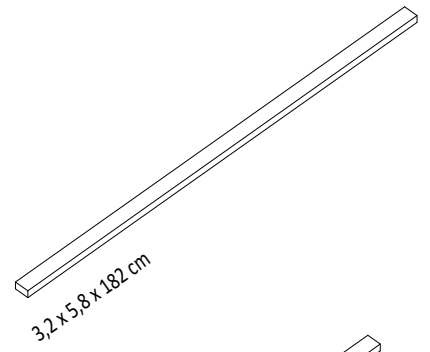

P-6

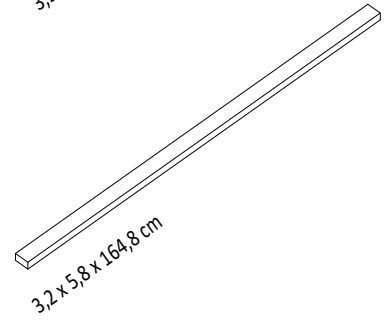

P-7

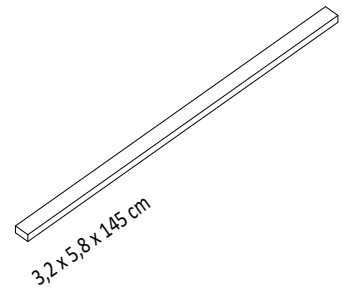

P-8a

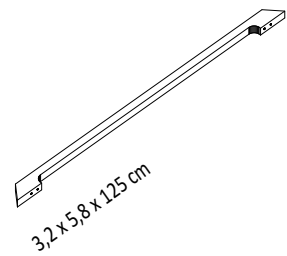

P-9a

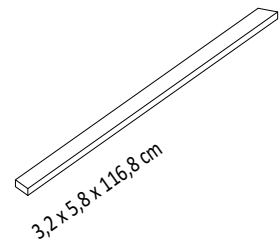

P-10

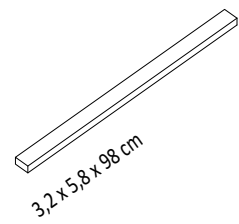

P-11

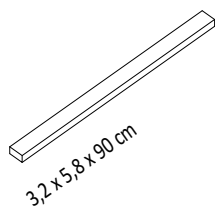

P-12

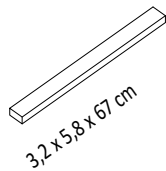

P-17a

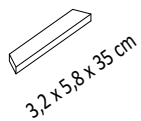

P-20

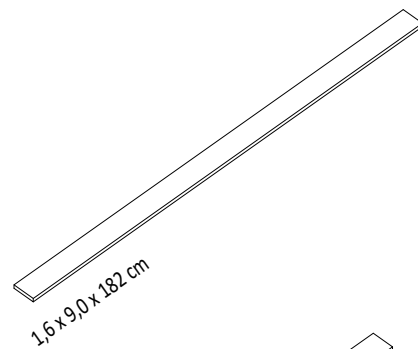

P-13

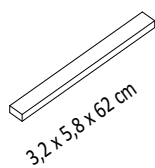

P-18

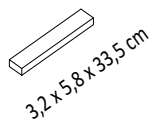

P-21

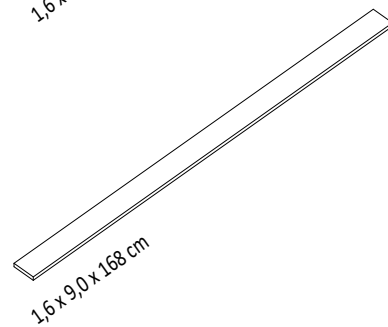

P-14

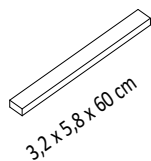

P-19a

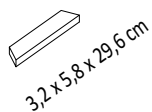

P-22a

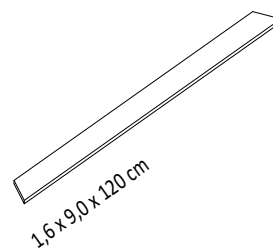

P-15

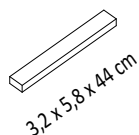

P-23

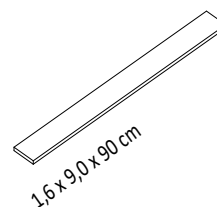

P-16a

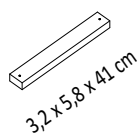

P-24

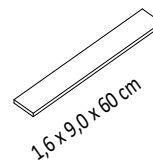

P-16b

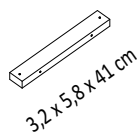

P-25a

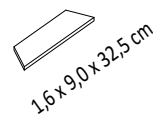

01

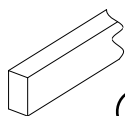
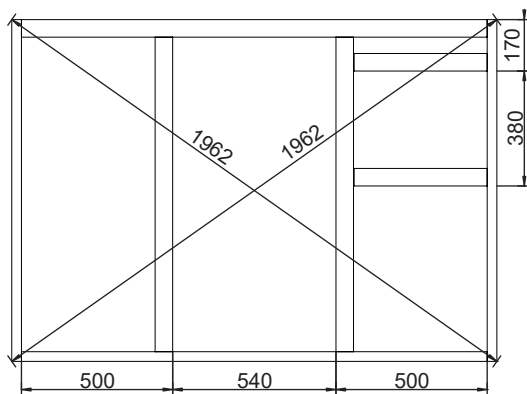
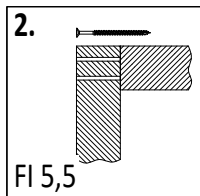
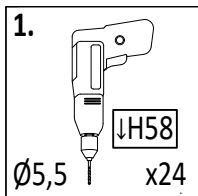

H-1 3,2x5,8x154cm

x2

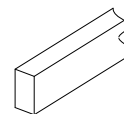

H-10 3,2x5,8x44cm

x2

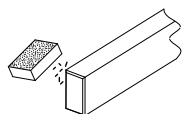

H-2 3,2x5,8x113cm

x2

H-4 3,2x5,8x104cm

x2



W80 x24

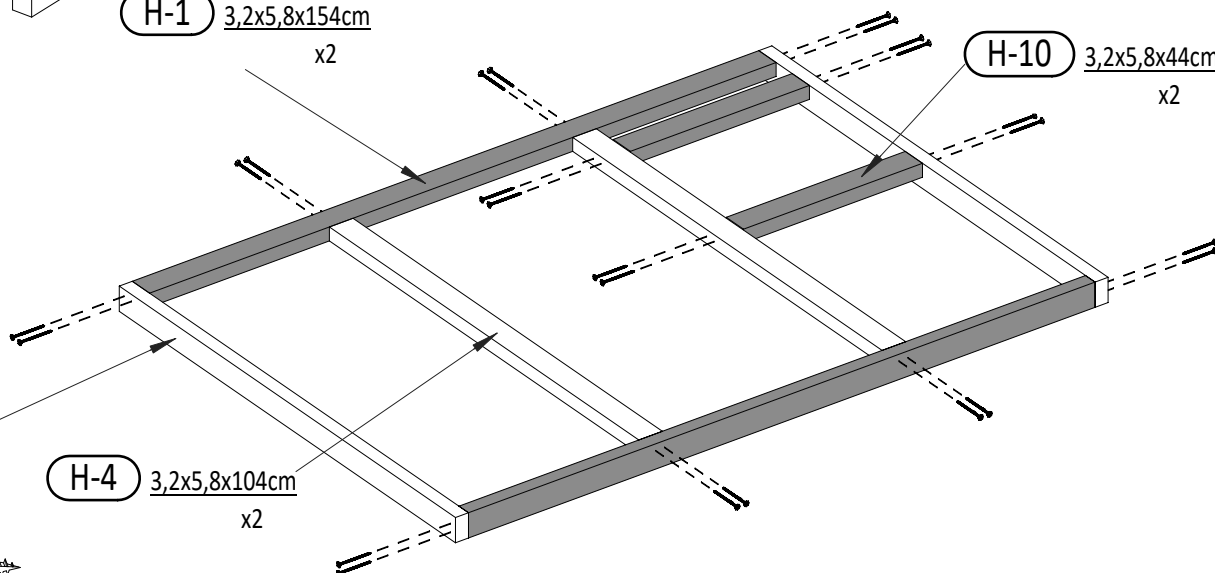

02

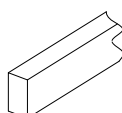
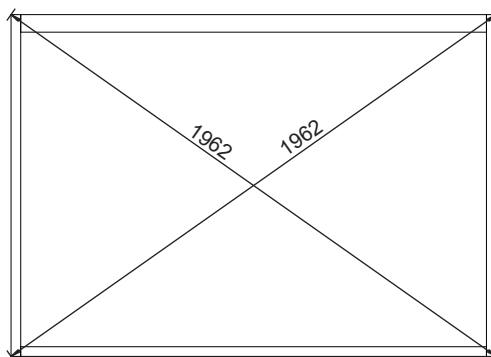
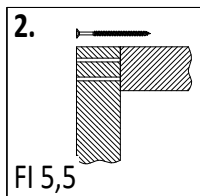
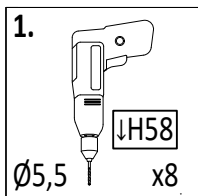

H-1 3,2x5,8x154cm

x2

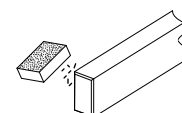

H-2 3,2x5,8x113cm

x2



W80 x8

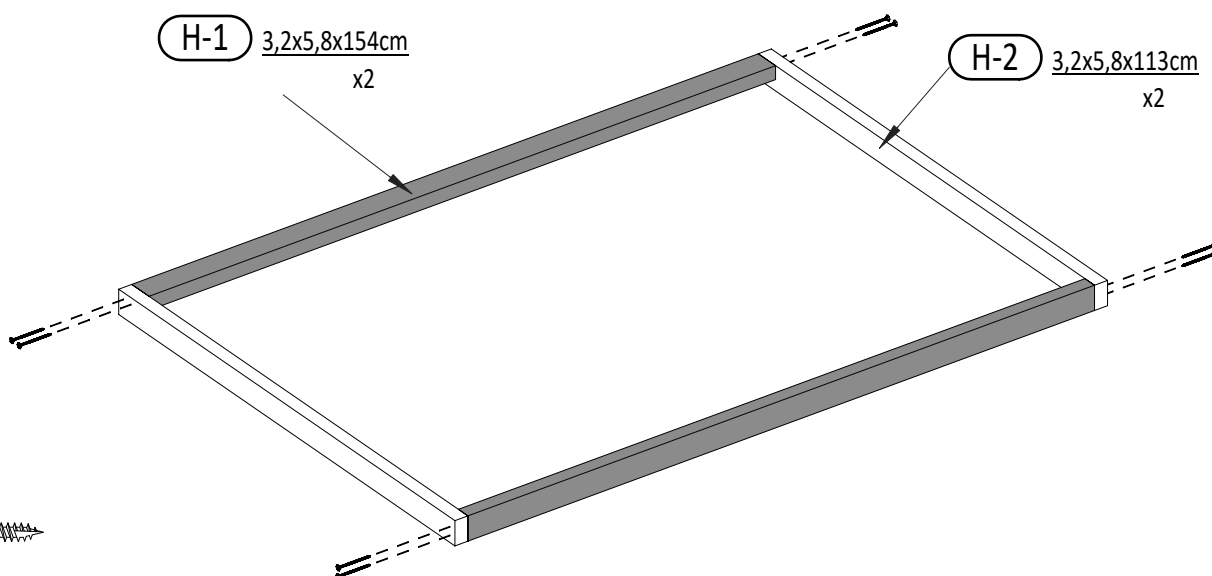

10

Zgodne z normą PN-EN 71 stosuj zalecenia producenta odnośnie odległości oraz metody mocowania poszczególnych elementów
In compliance with the standard PN-EN 71, apply guidelines of the producer in relation to distances and methods of fastening individual elements

GX_SUNSHINE V2

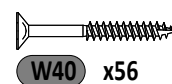
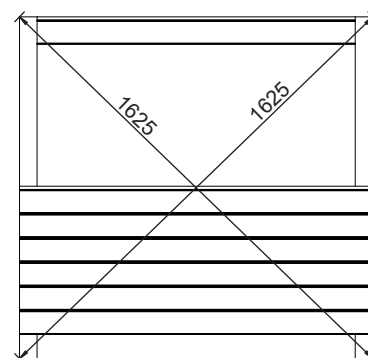
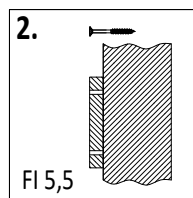
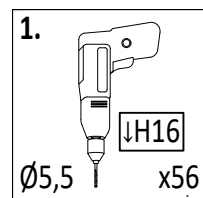
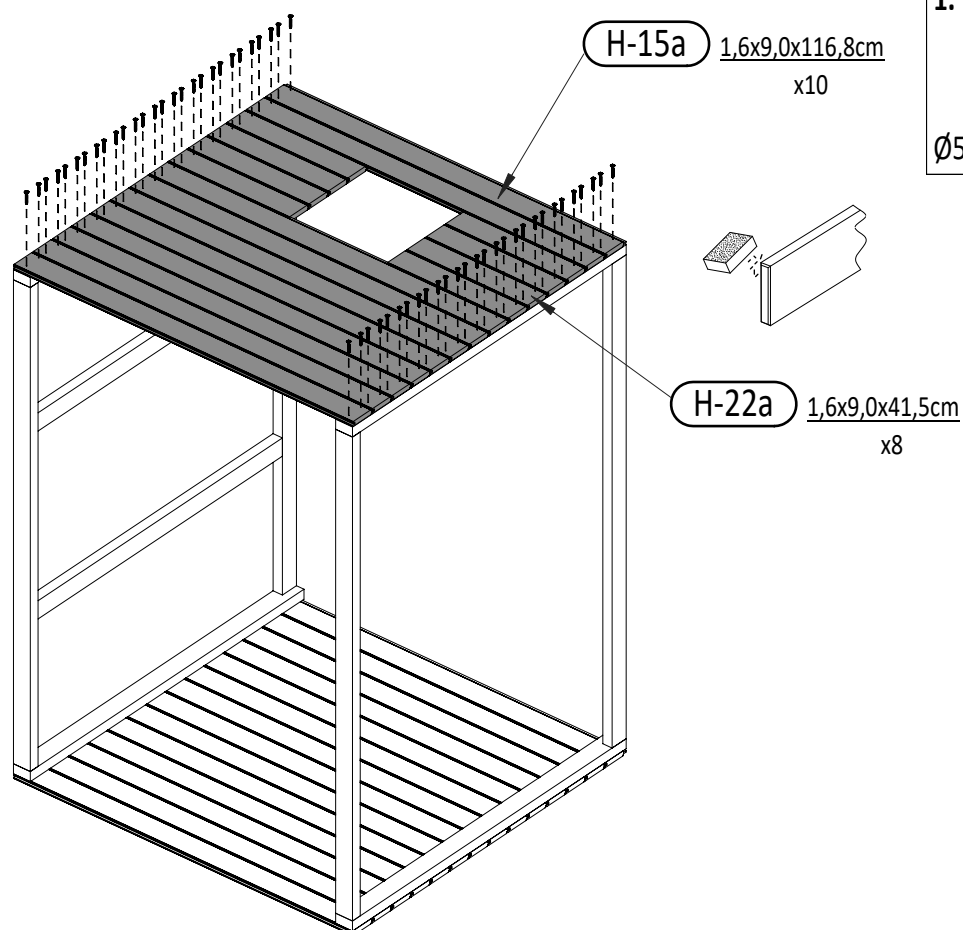
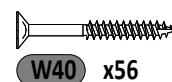
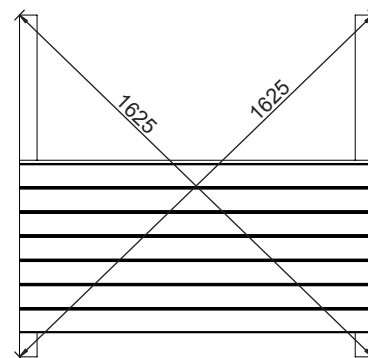
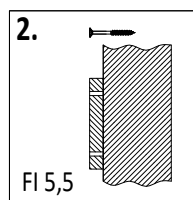
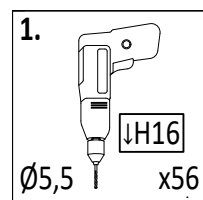
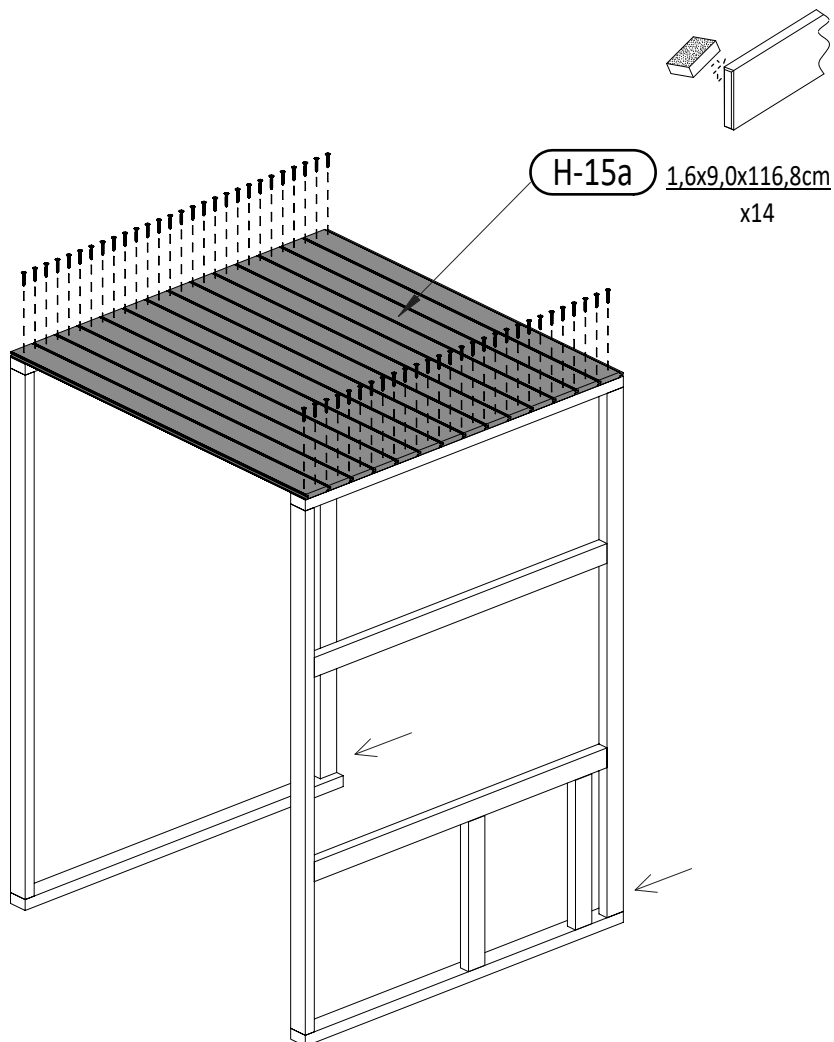

05

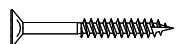
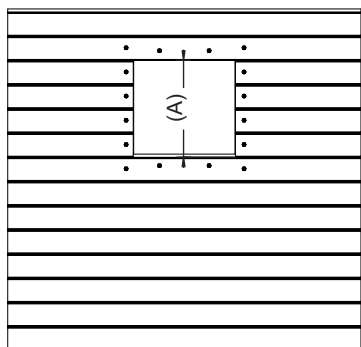
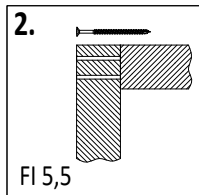
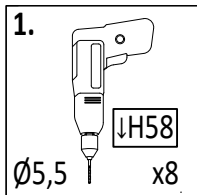

W40 x16

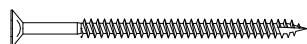

W80 x8

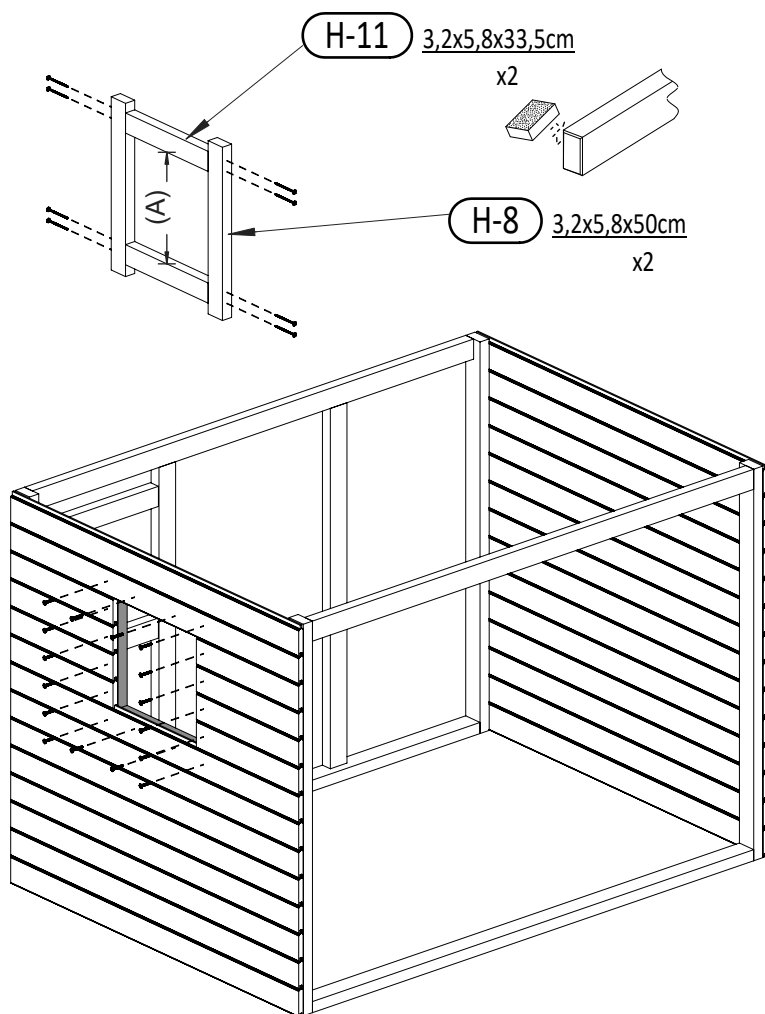

06

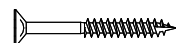
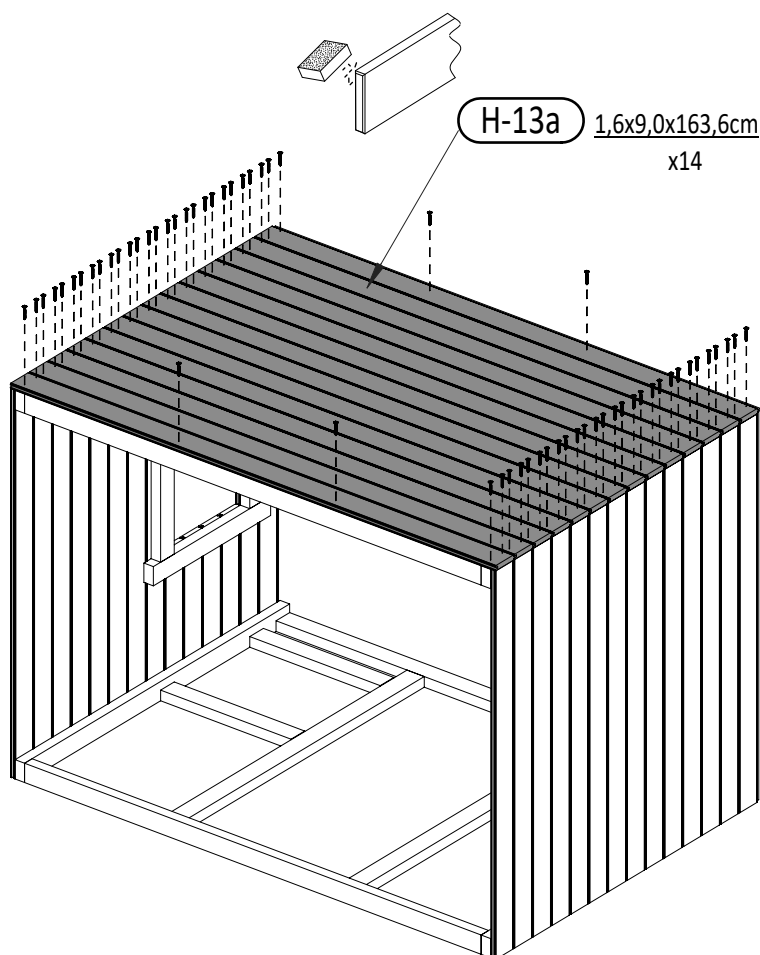
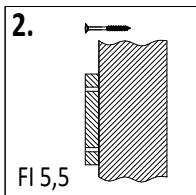
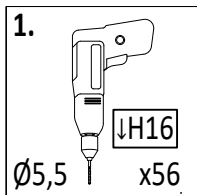

W40 x60

12

Zgodnie z normą PN-EN 71 stosuj zalecenia producenta odnośnie odległości oraz metody mocowania poszczególnych elementów
In compliance with the standard PN-EN 71, apply guidelines of the producer in relation to distances and methods of fastening individual elements

GX_SUNSHINE V2

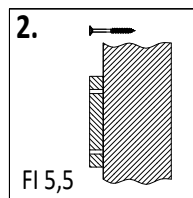
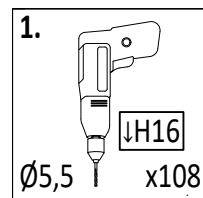
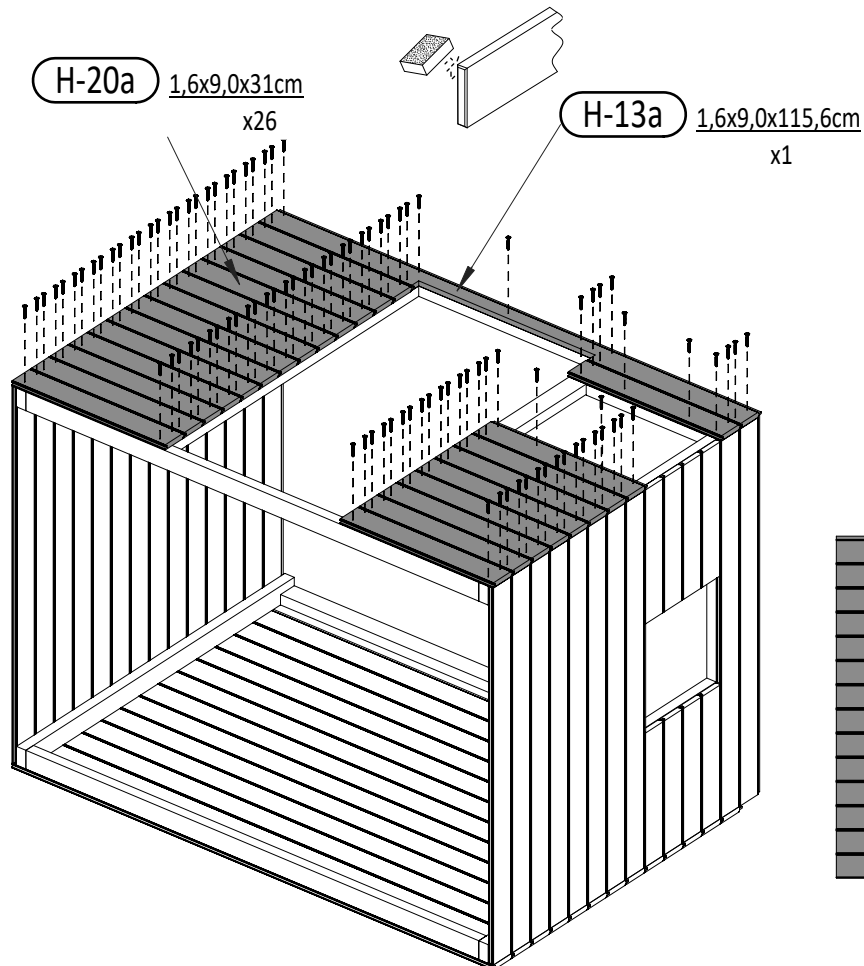

07

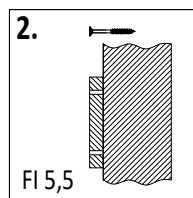
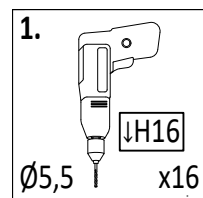
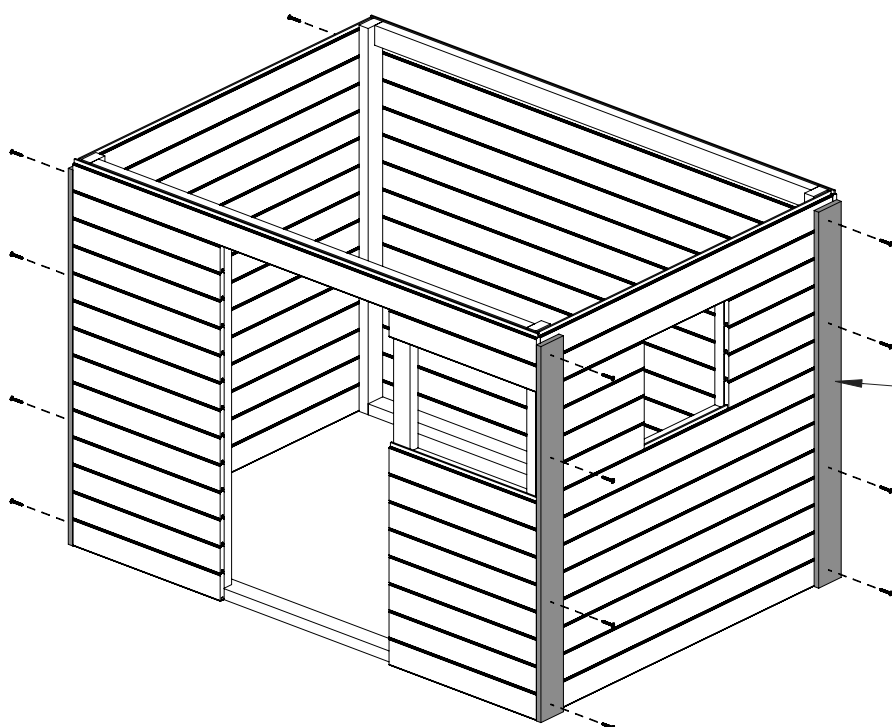
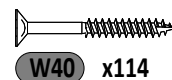
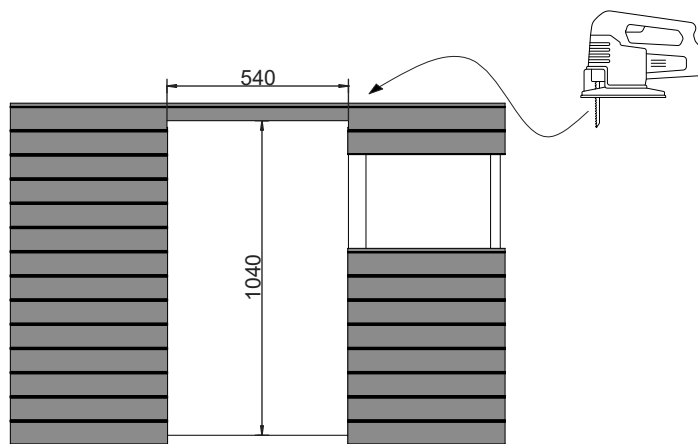

08

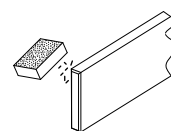

H-17 1,6x9,0x110cm
x4

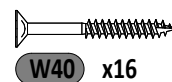

13

09

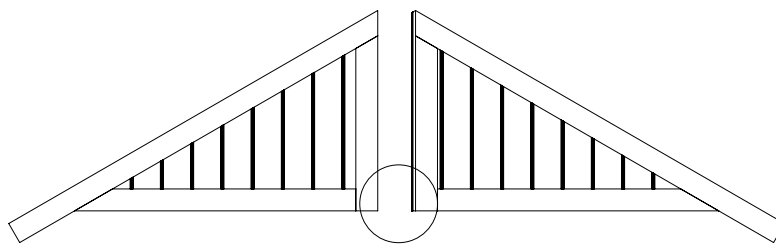
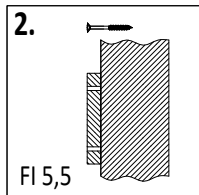
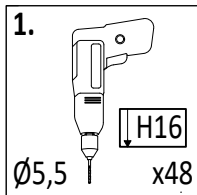

!!! x2

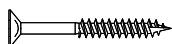
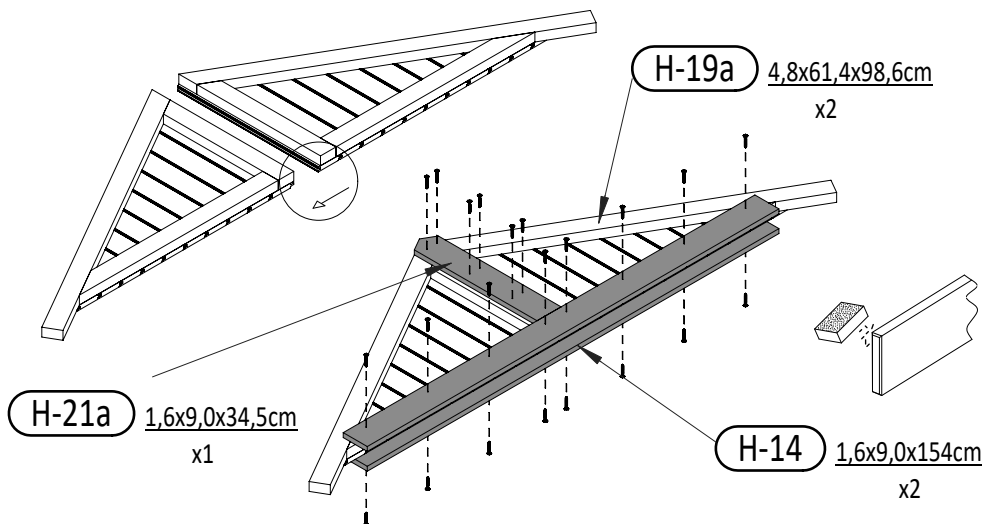

W40 x24*2 = 48

10

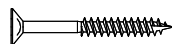
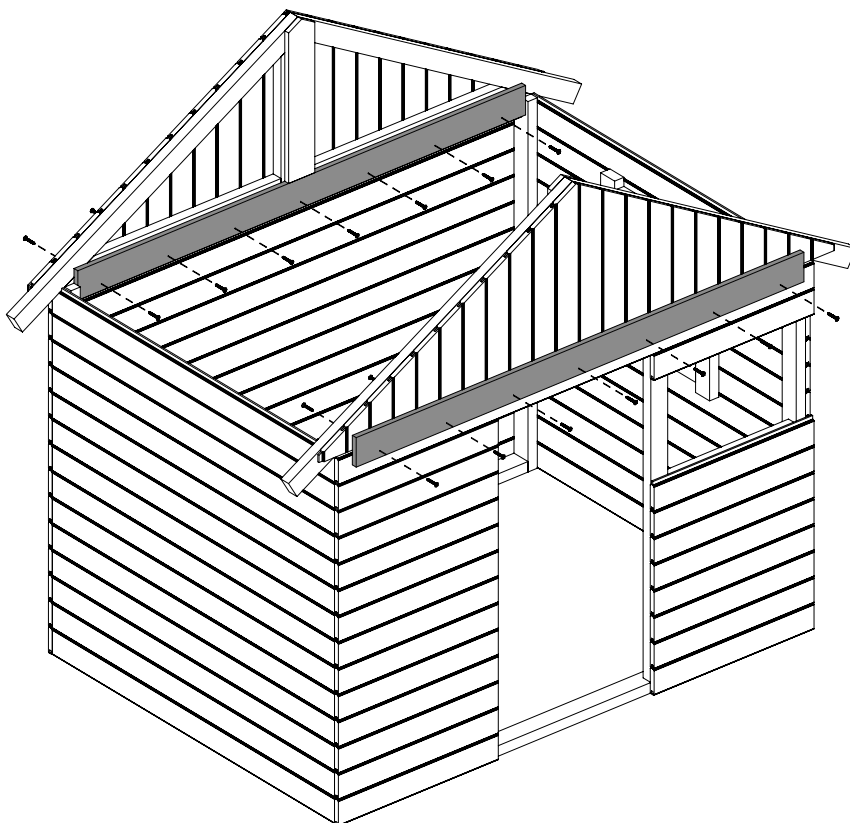
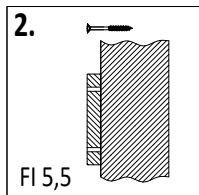
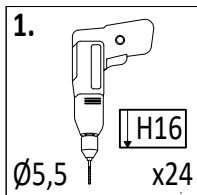

W40 x24

14

Zgodne z normą PN-EN 71 stosuj zalecenia producenta odnośnie odległości oraz metody mocowania poszczególnych elementów
In compliance with the standard PN-EN 71, apply guidelines of the producer in relation to distances and methods of fastening individual elements

GX_SUNSHINE V2

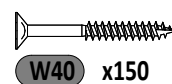
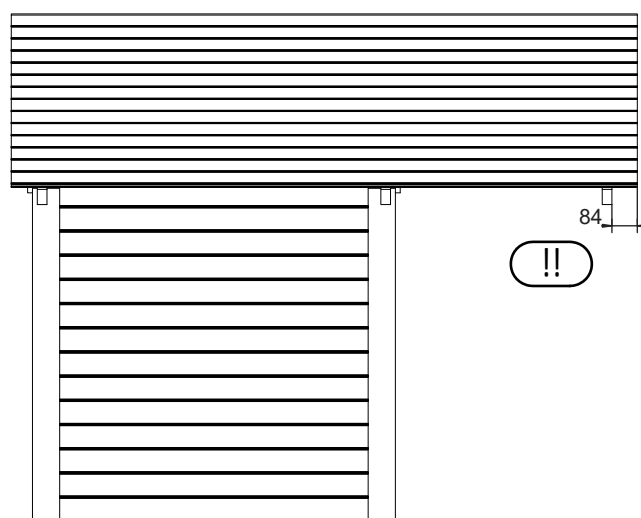
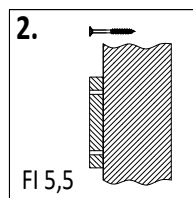
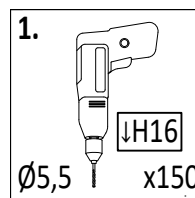
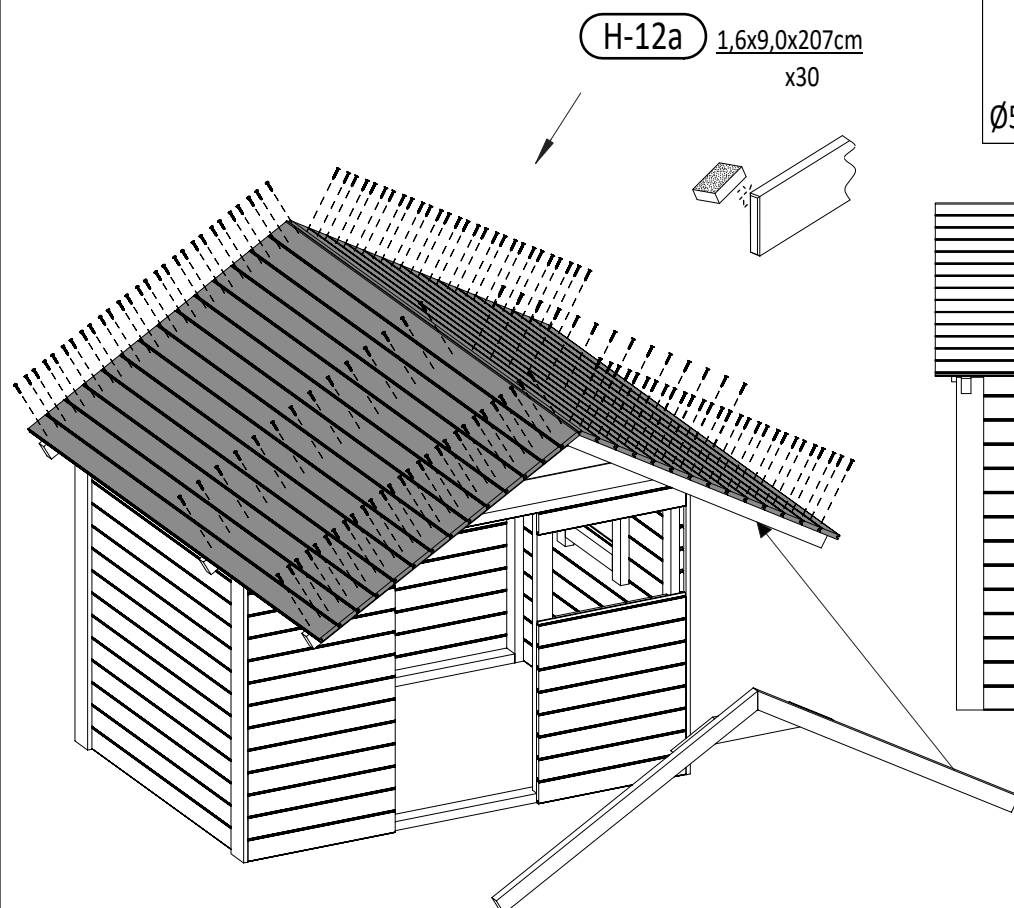
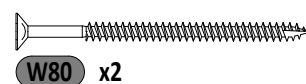
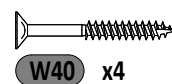
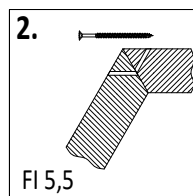
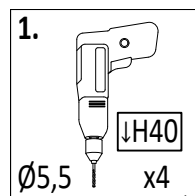
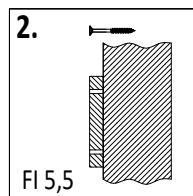
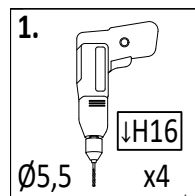
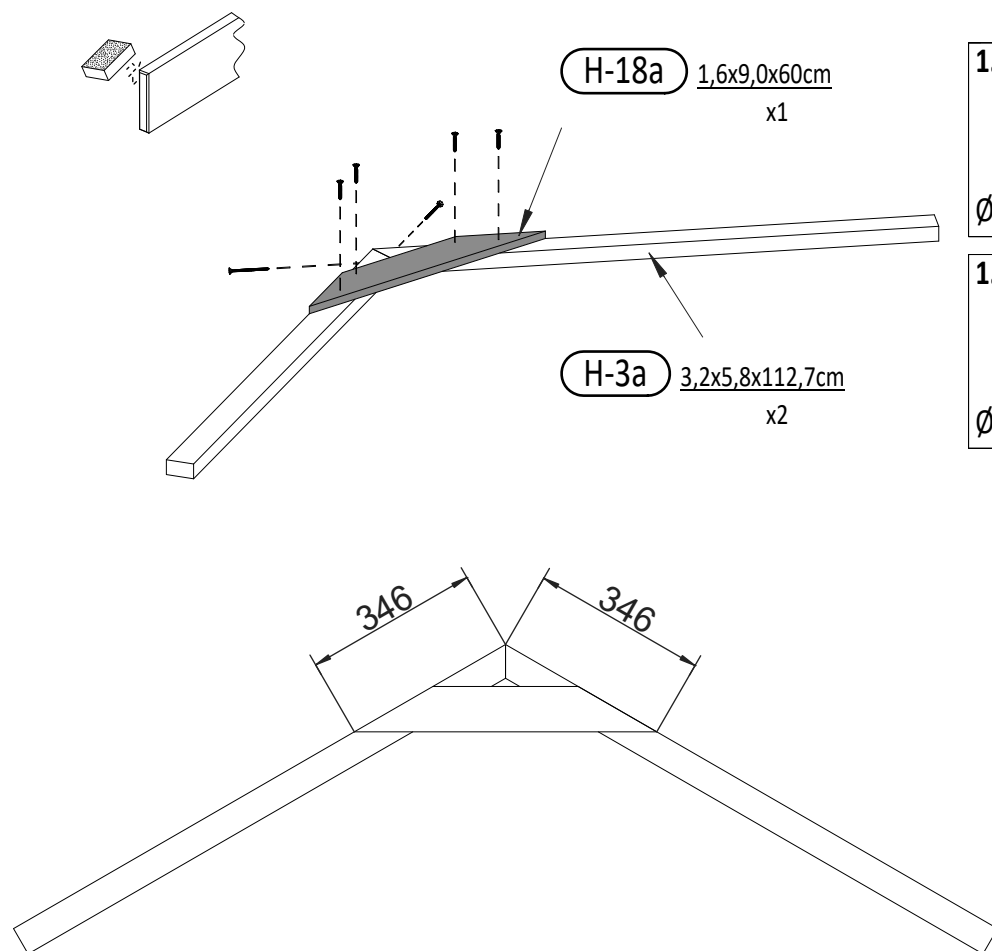

13

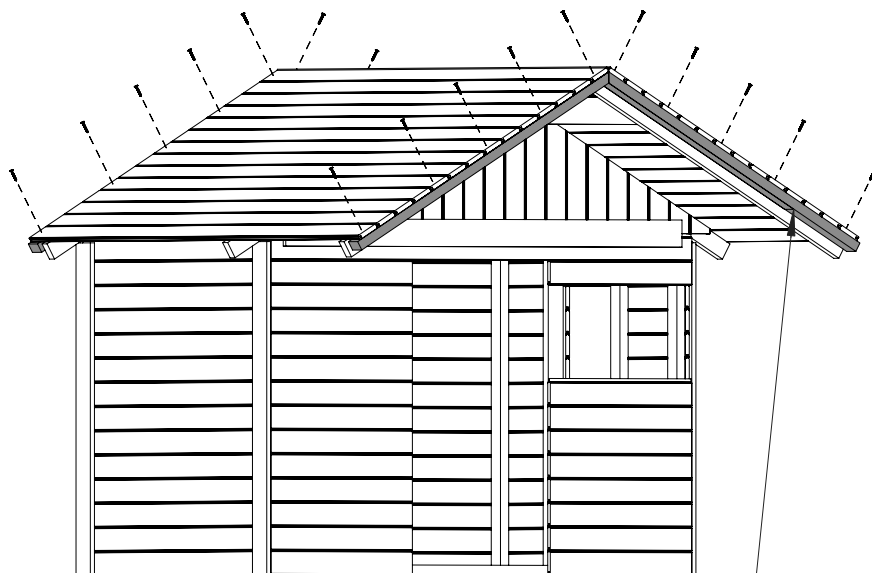
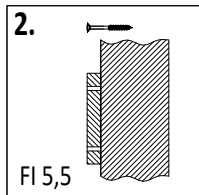
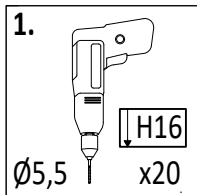

H-3b 3,2x5,8x112,7cm
x4

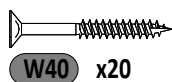
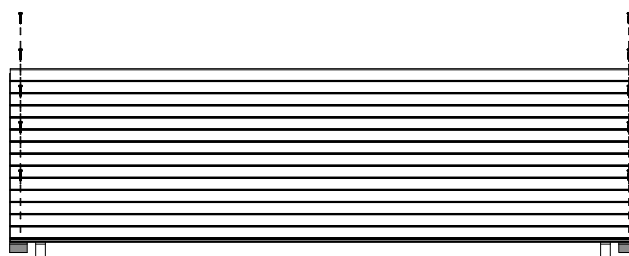

14

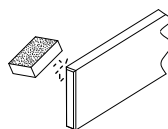
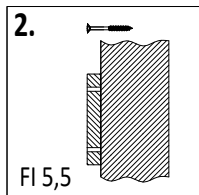
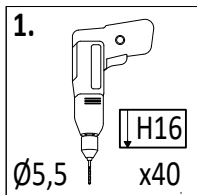

H-24 1,6x3,5x207cm
x1

H-16a 1,6x9,0x116cm
x4

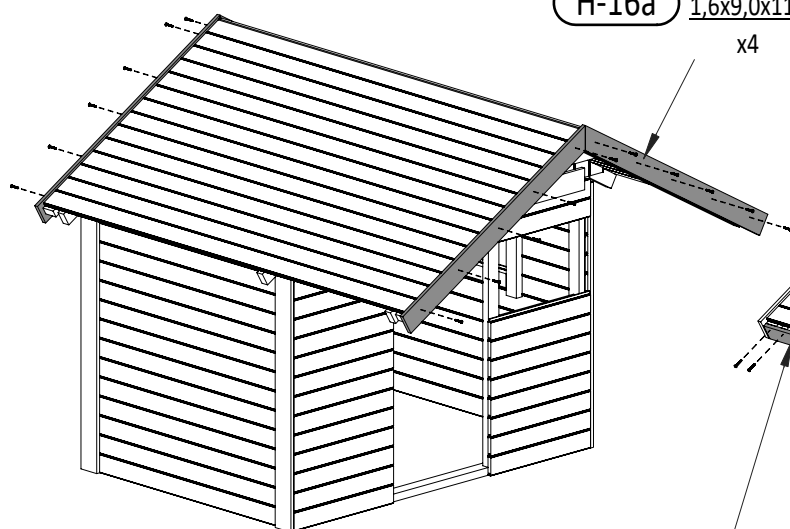

H-23 1,6x7,0x207cm
x2

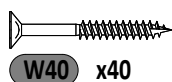
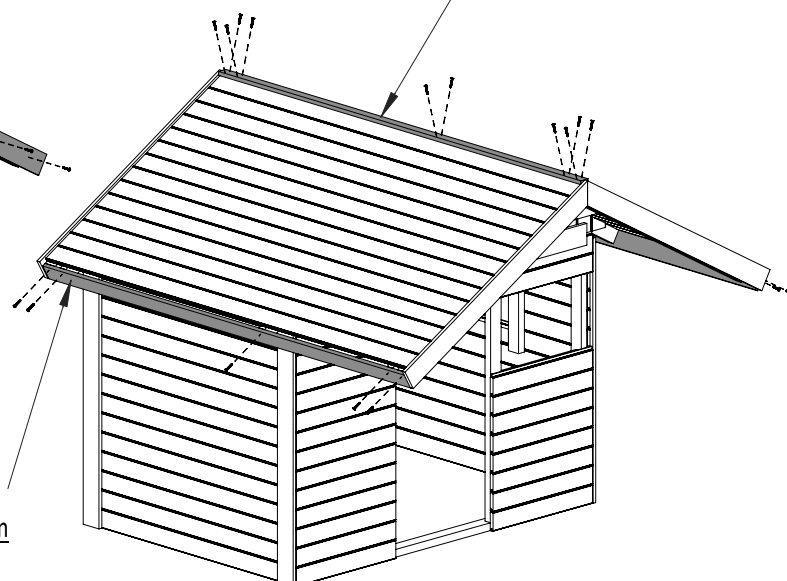

16

Zgodnie z normą PN-EN 71 stosuj zalecenia producenta odnośnie odległości oraz metody mocowania poszczególnych elementów
In compliance with the standard PN-EN 71, apply guidelines of the producer in relation to distances and methods of fastening individual elements

GX_SUNSHINE V2

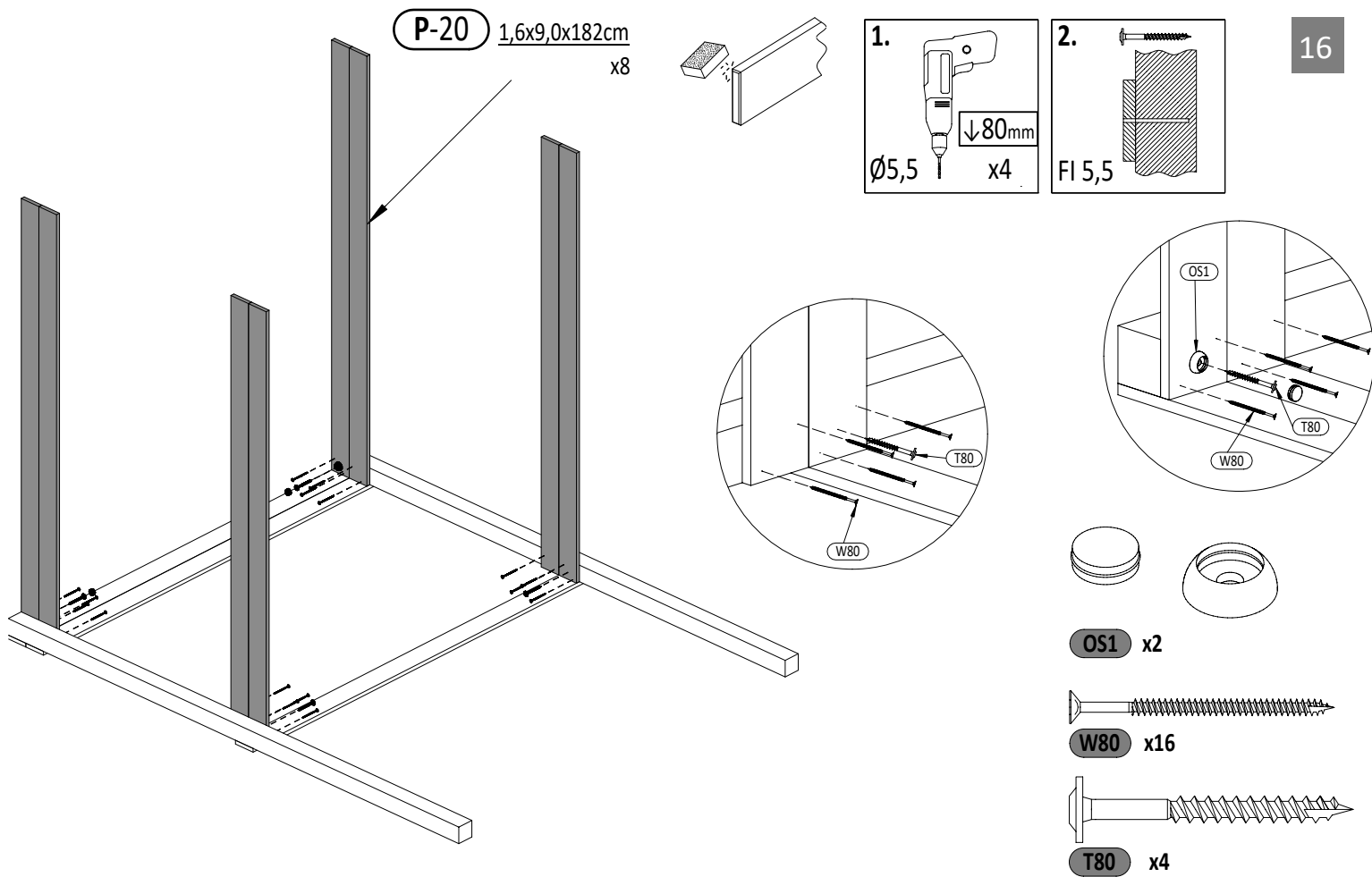
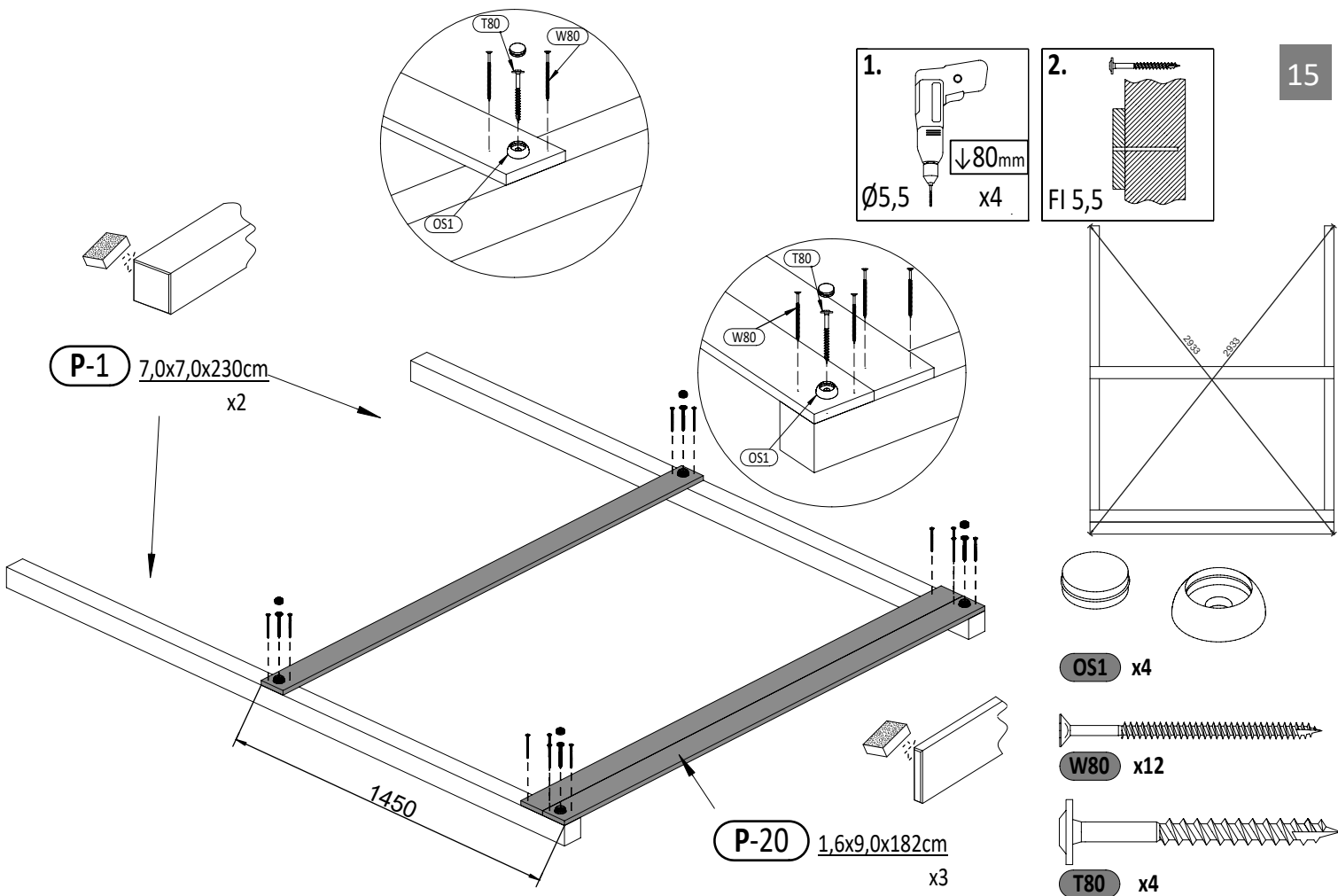

17

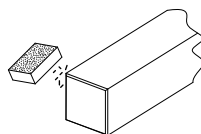
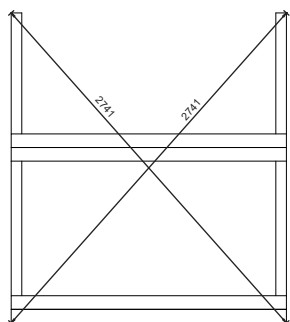
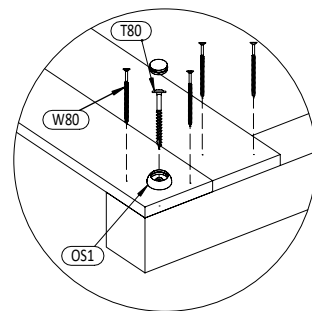
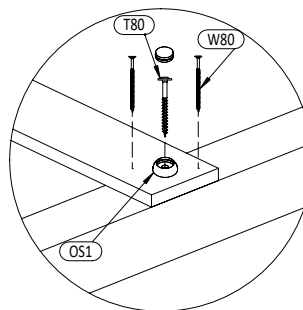
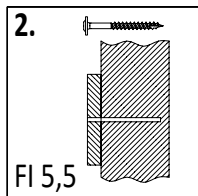
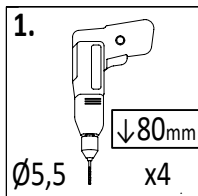

P-2 7,0x7,0x205cm
x2

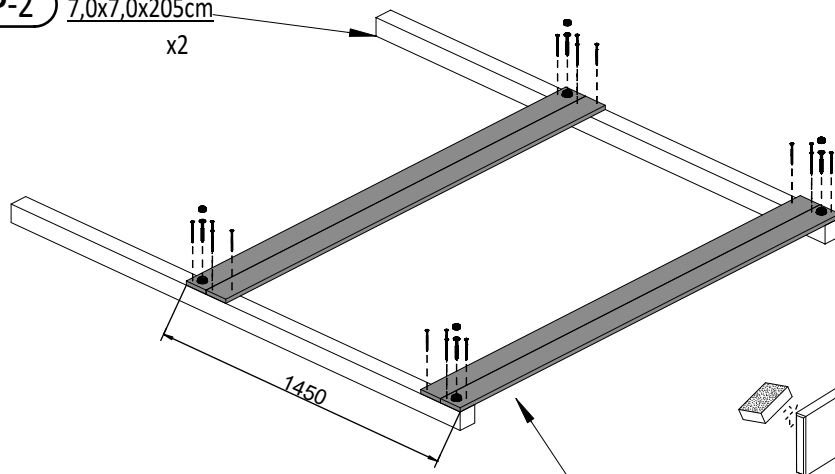

P-20 1,6x9,0x182cm
x4

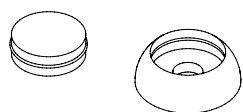

OS1 x4

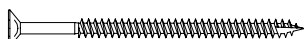

W80 x16

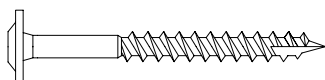

T80 x4

18

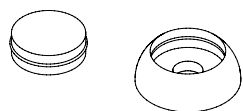
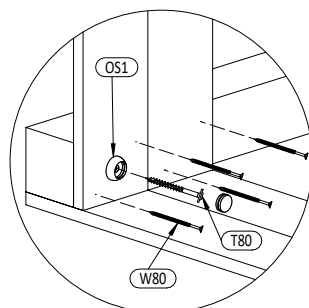
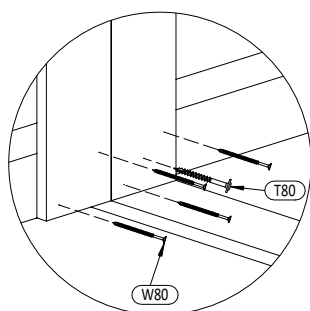
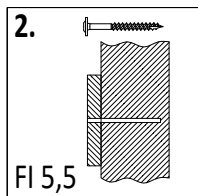
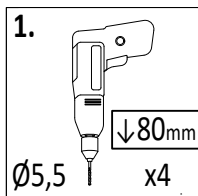

OS1 x2



W80 x16

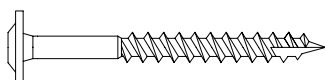

T80 x4

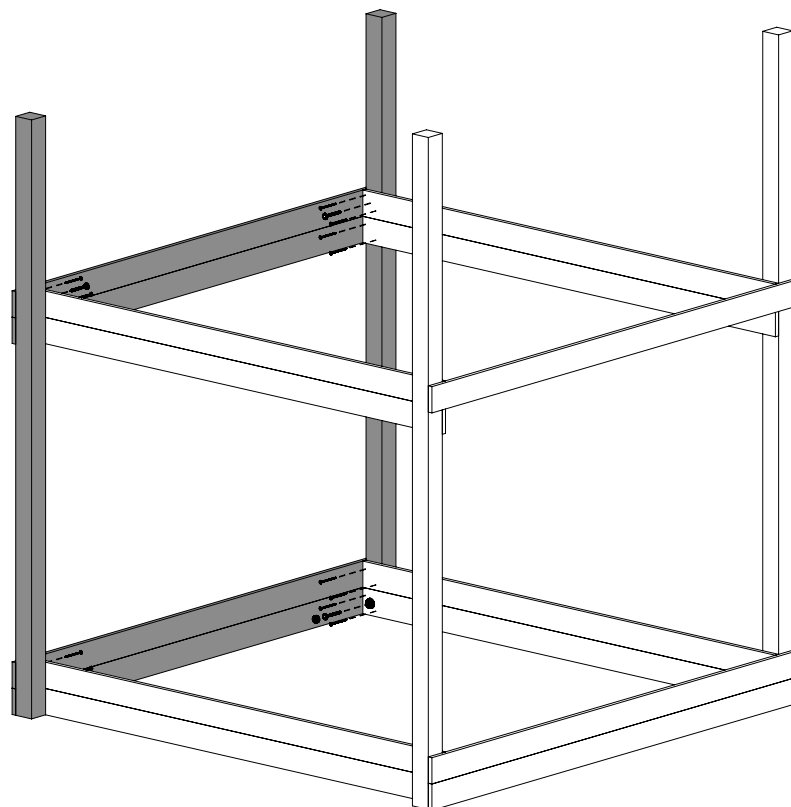

18

Zgodnie z normą PN-EN 71 stosuj zalecenia producenta odnośnie odległości oraz metody mocowania poszczególnych elementów

In compliance with the standard PN-EN 71, apply guidelines of the producer in relation to distances and methods of fastening individual elements

GX_SUNSHINE V2

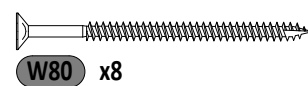
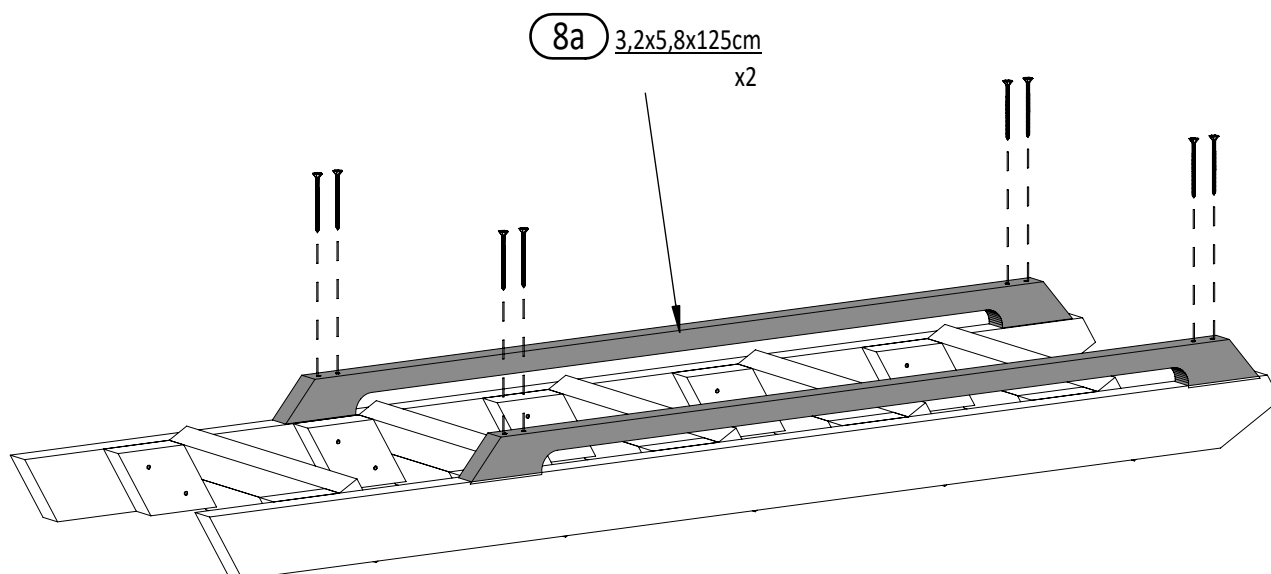
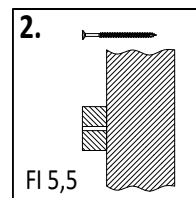
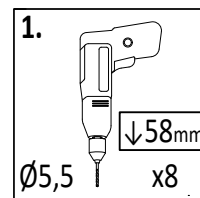
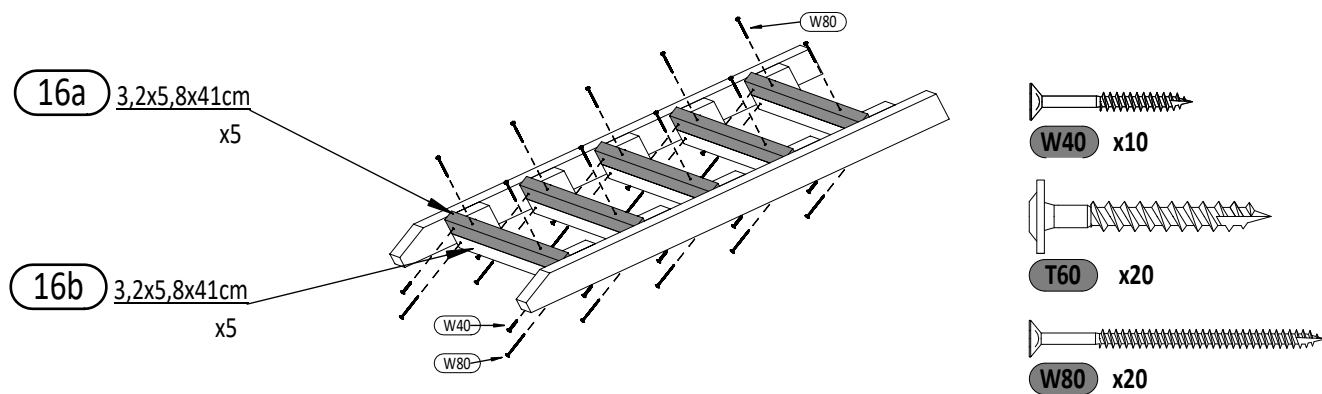
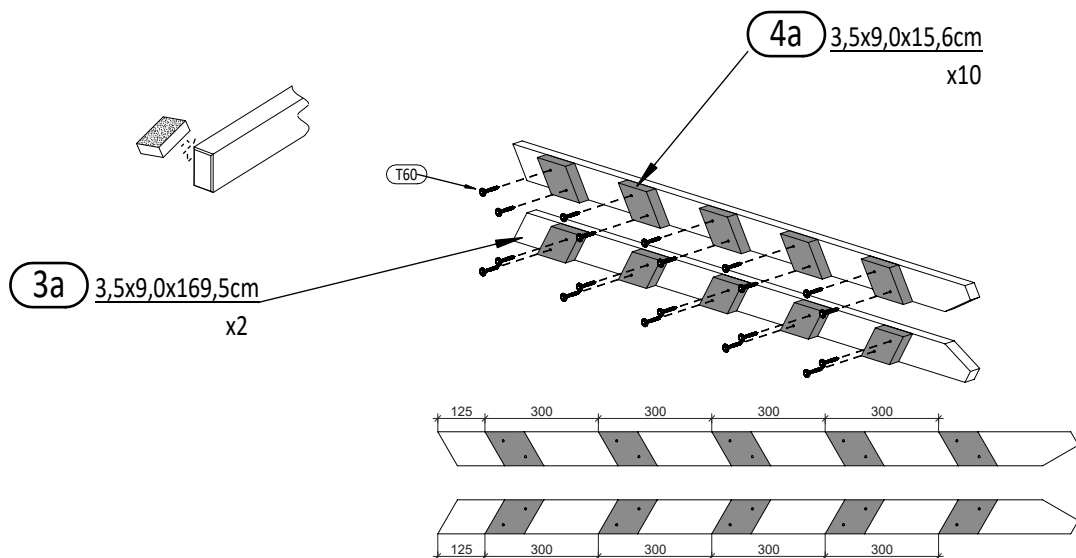

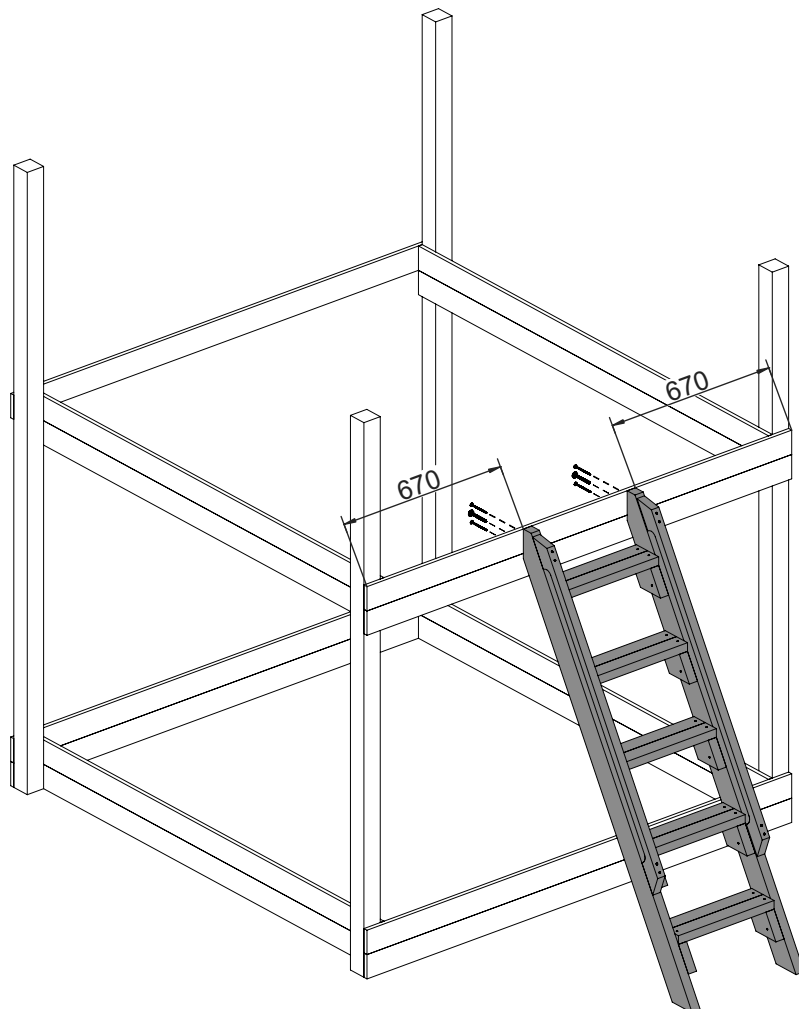
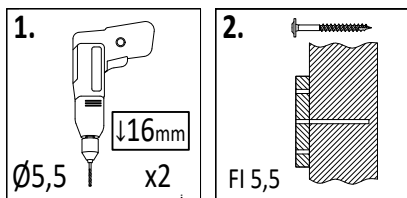

W80 x4

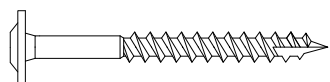

T80 x2

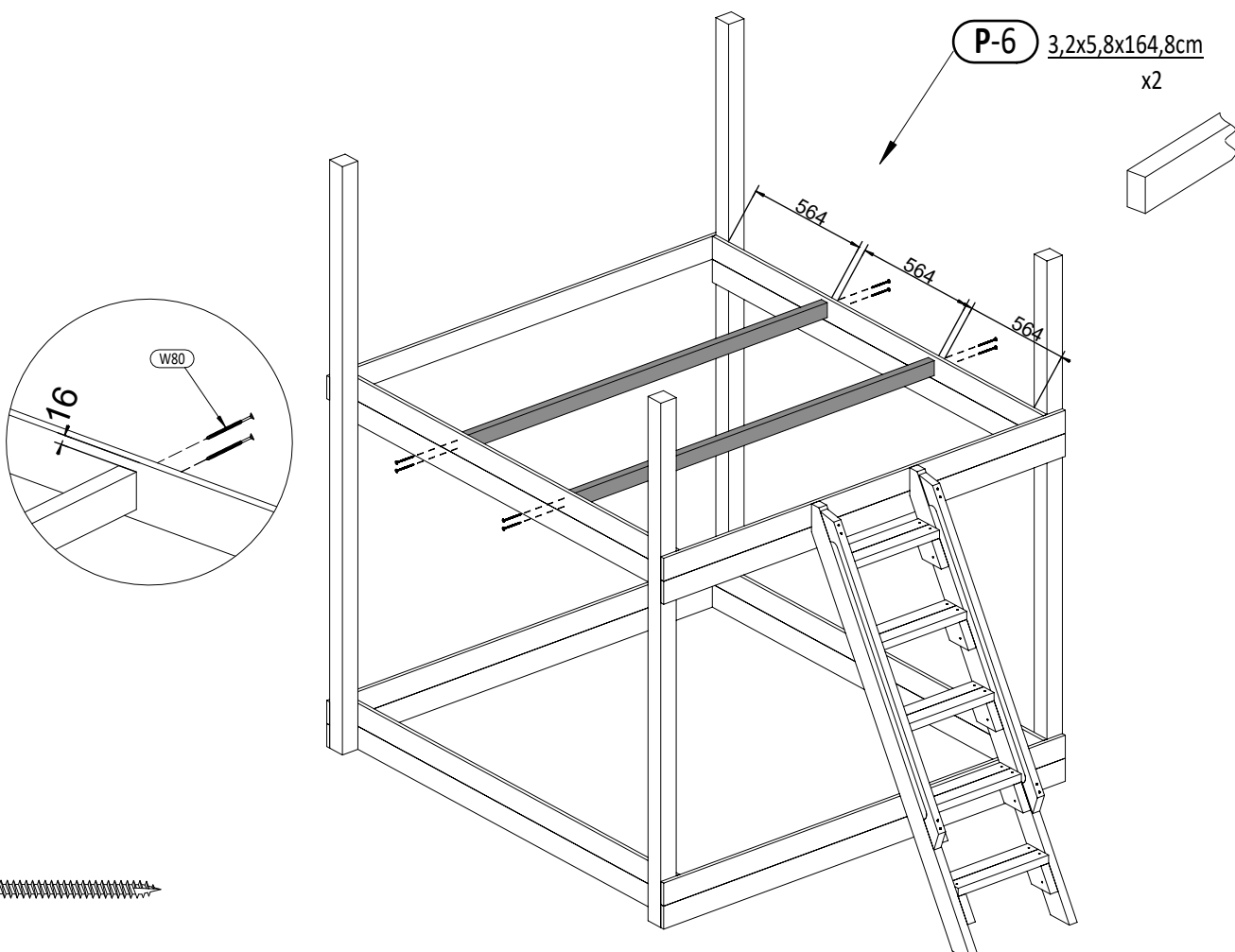

W80 x8

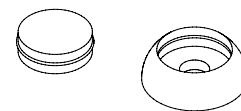
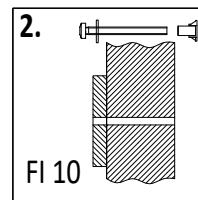
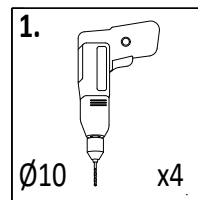
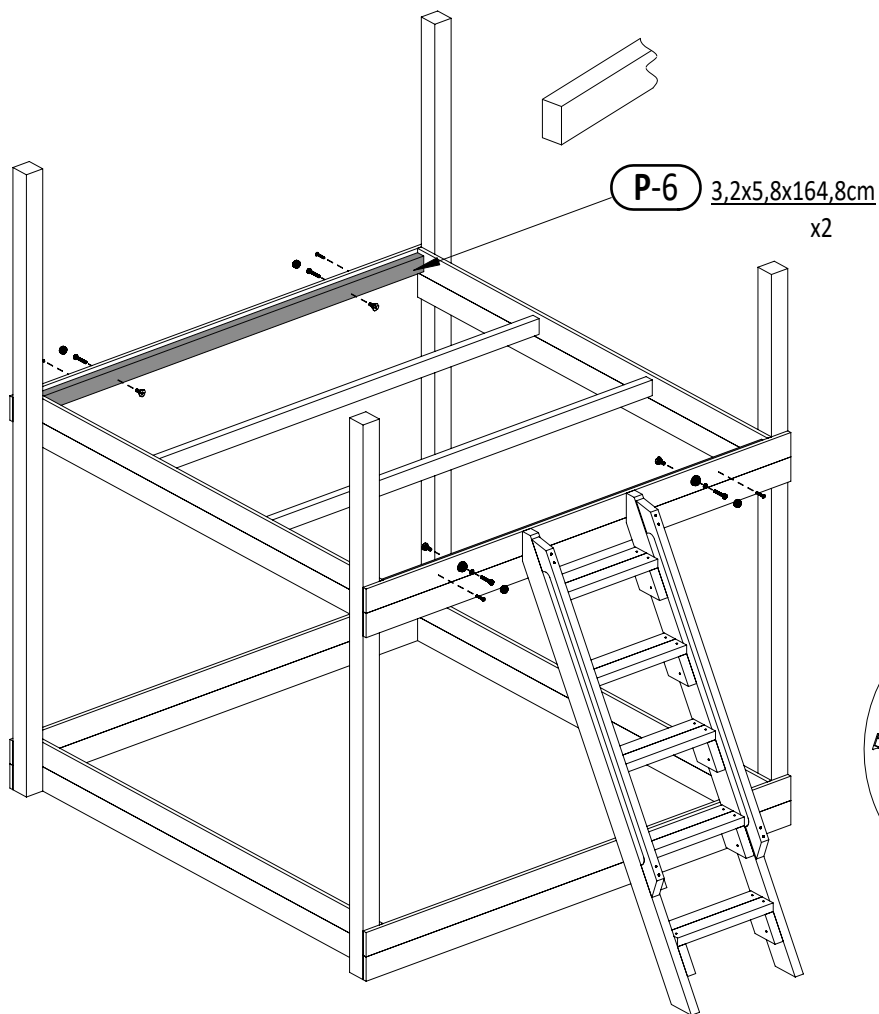

OS1 x4

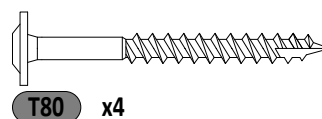
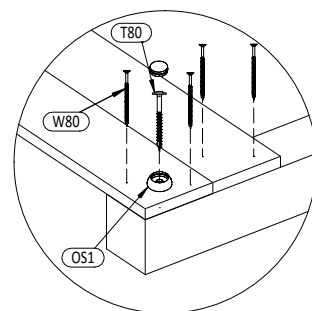
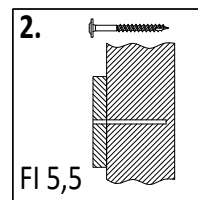
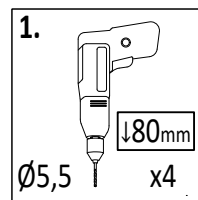
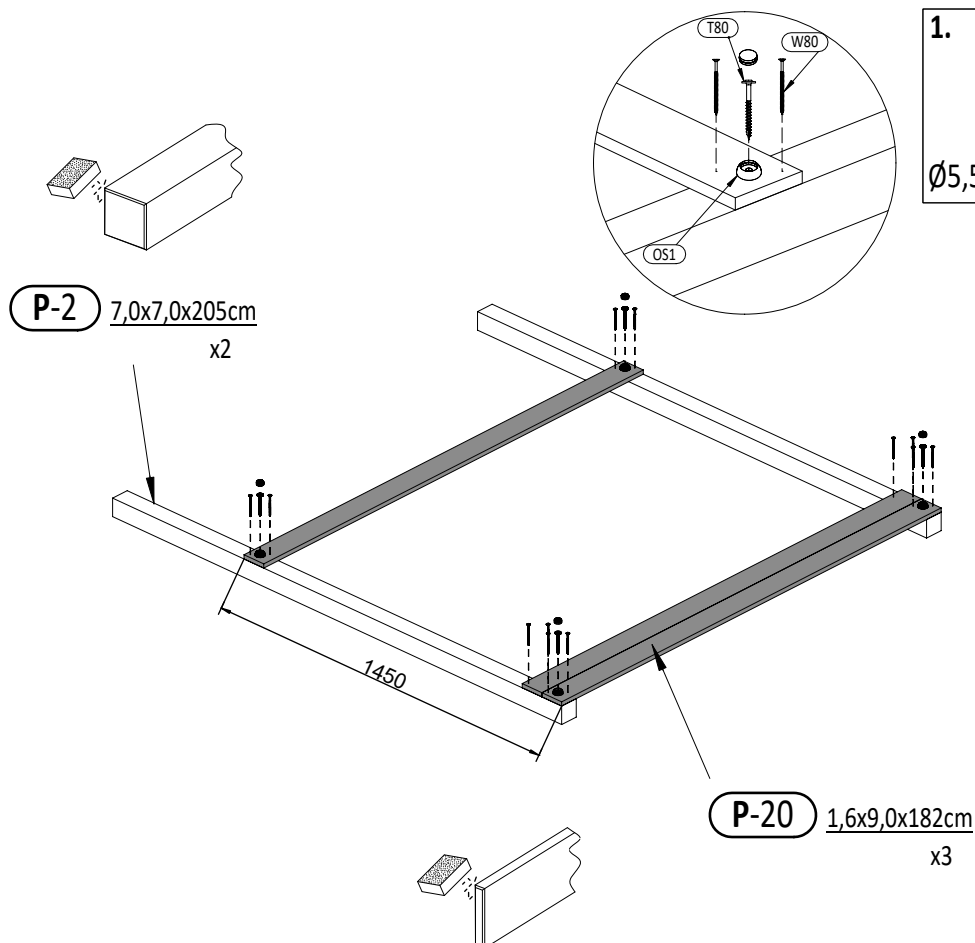
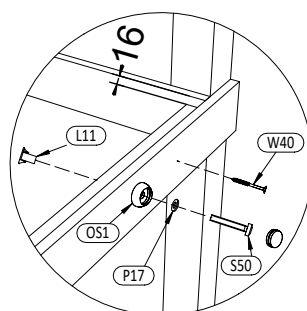
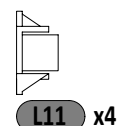
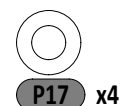
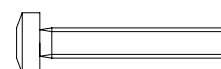
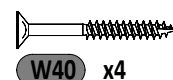

25

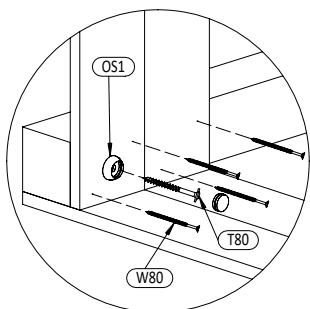
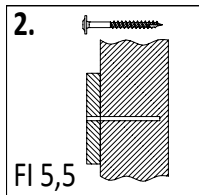
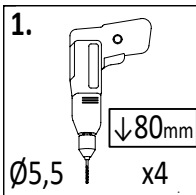

OS1 x2

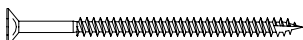

W80 x12

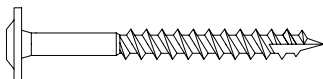

T80 x4

P-23 1,6x9,0x90cm
x6

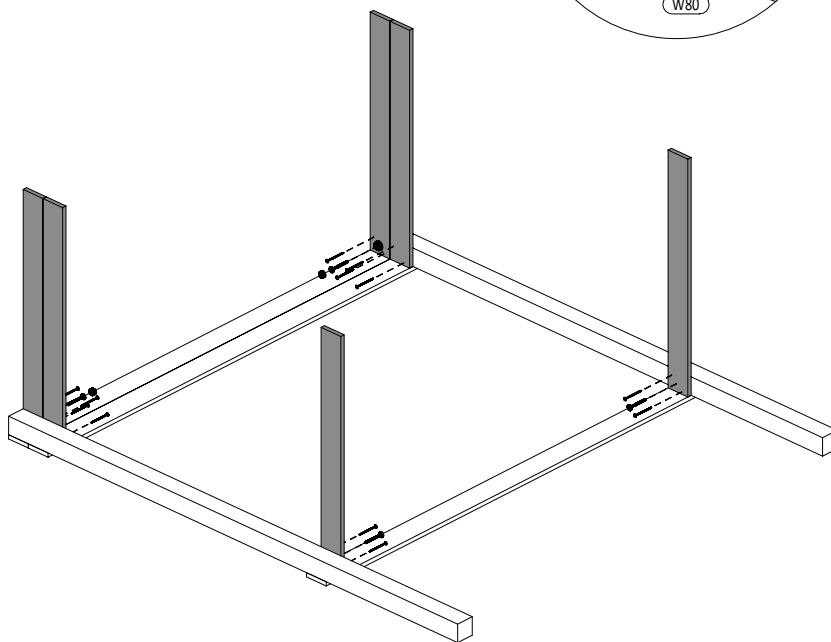
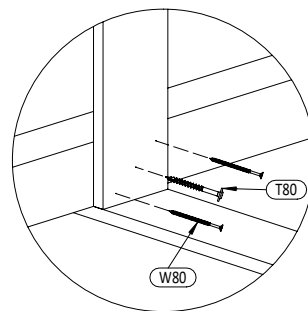

26

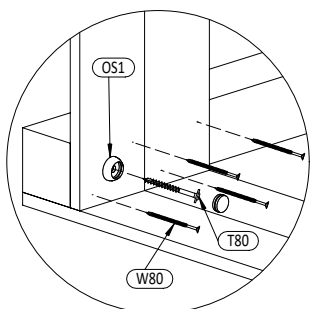
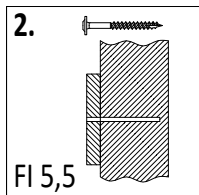
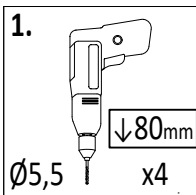

OS1 x2



W80 x12

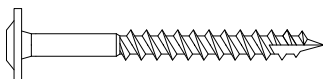

T80 x4

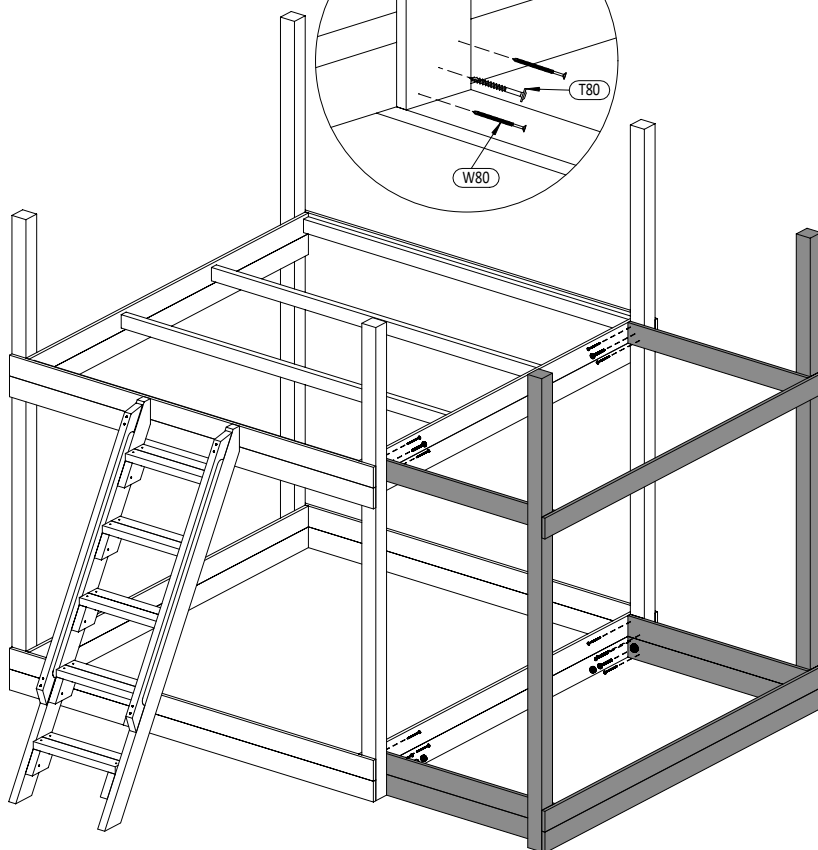
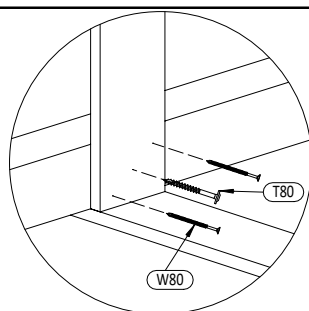

22

Zgodnie z normą PN-EN 71 stosuj zalecenia producenta odnośnie odległości oraz metody mocowania poszczególnych elementów
In compliance with the standard PN-EN 71, apply guidelines of the producer in relation to distances and methods of fastening individual elements

GX_SUNSHINE V2

P-6 3,2x5,8x164,8cm

x3

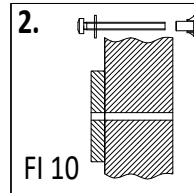
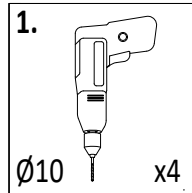
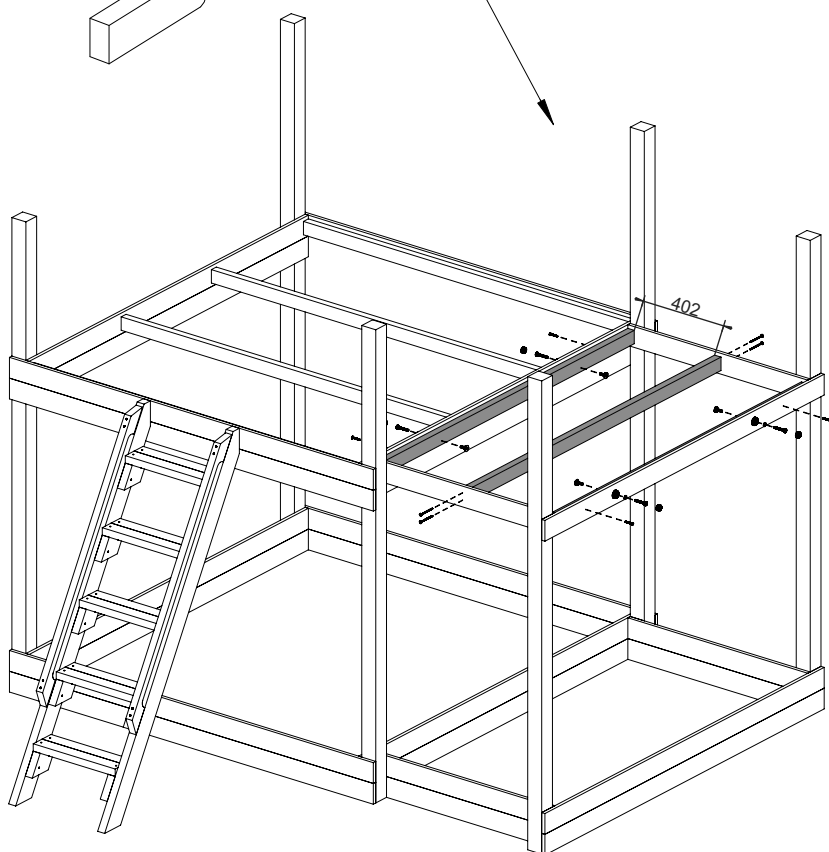

27

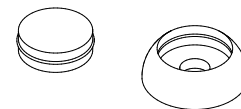
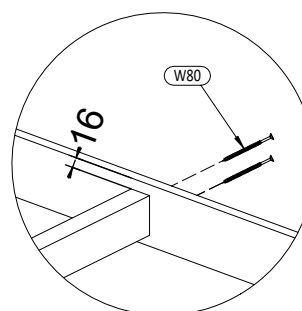
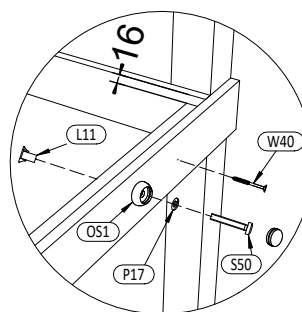

OS1 x4



W40 x4

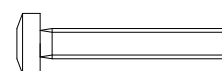

S50 x4



P17 x4



L11 x4

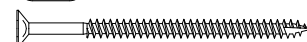

W80 x4

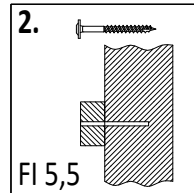
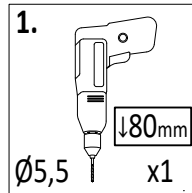

28

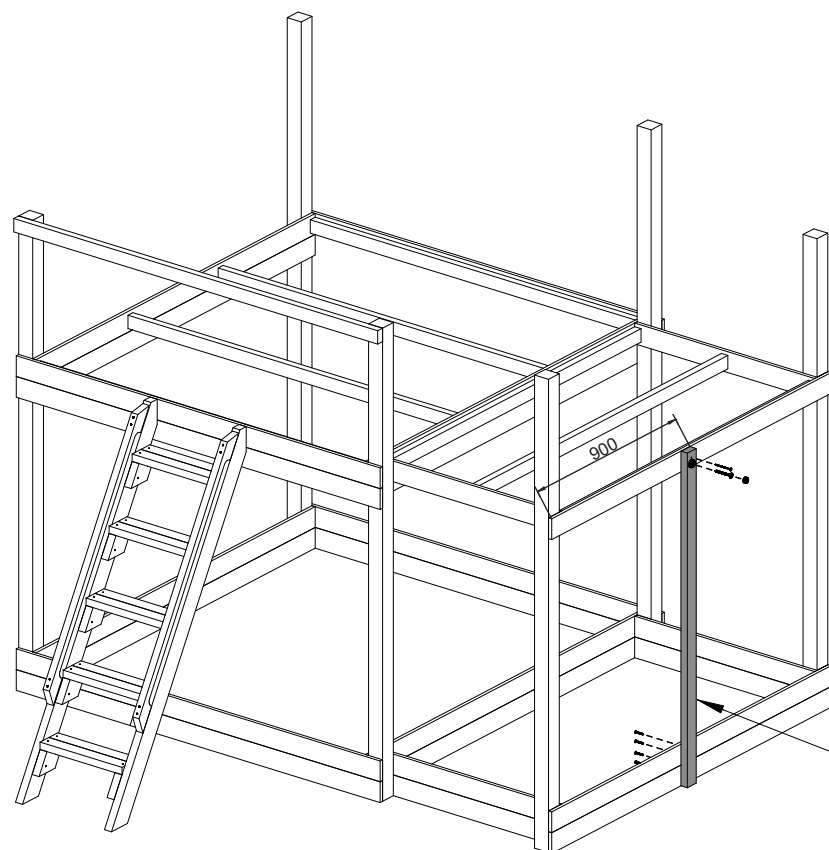

P-7 3,2x5,8x145cm

x1

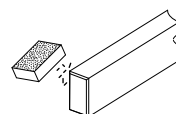

OS1 x1



W40 x4

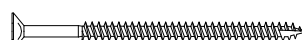

W80 x1



T80 x1

Zgodnie z normą PN-EN 71 stosuj zalecenia producenta odnośnie odległości oraz metody mocowania poszczególnych elementów

In compliance with the standard PN-EN 71, apply guidelines of the producer in relation to distances and methods of fastening individual elements

23

GX_SUNSHINE V2

29

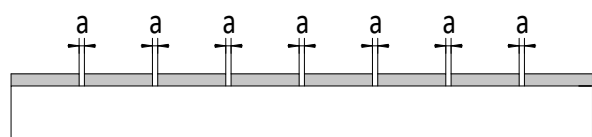
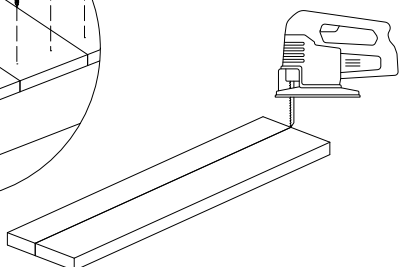
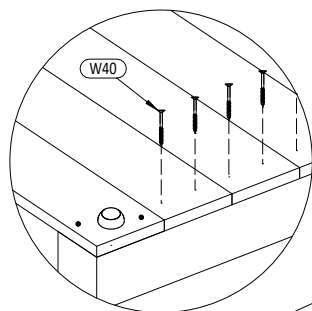
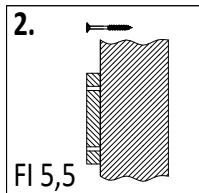
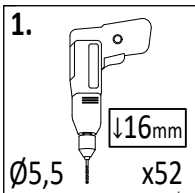

!!!min 2mm < a < !!!max 6mm

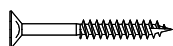

W40 x52

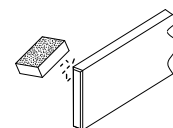

P-23 1,6x9,0x90cm
x13

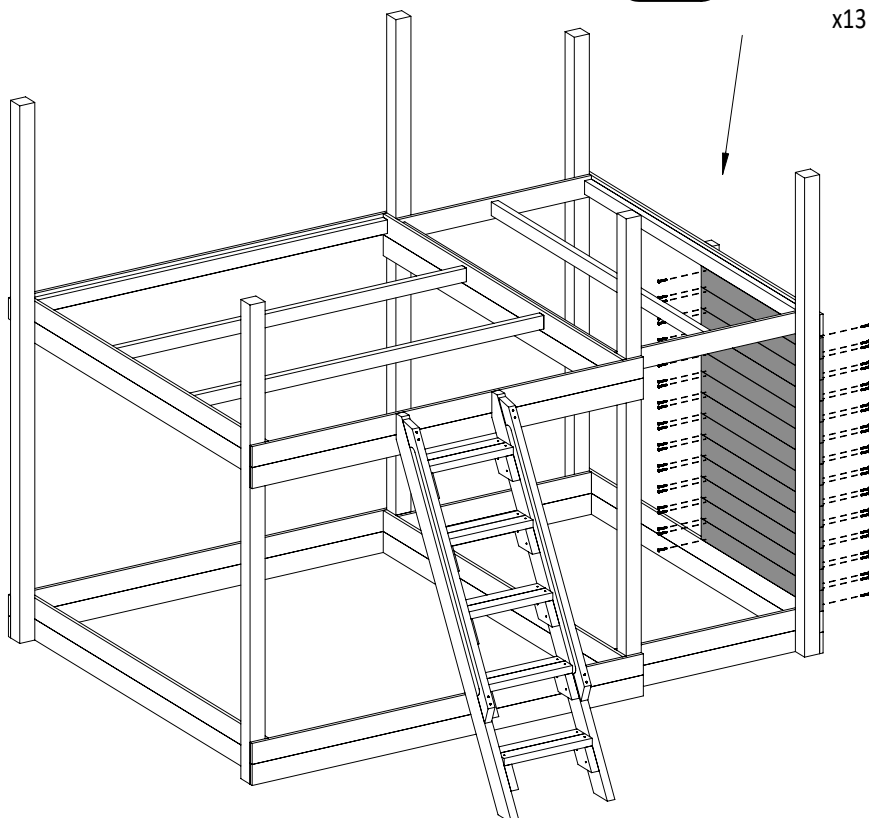

30

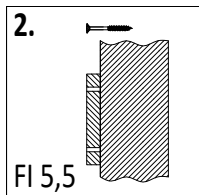
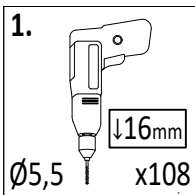

P-20 1,6x9,0x182cm
x11

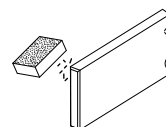

P-23 1,6x9,0x90cm
x16

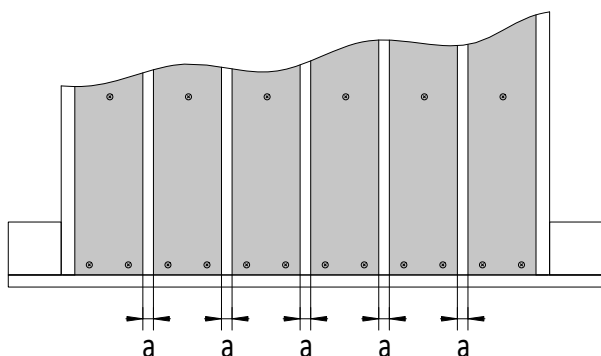

!!!min 13mm < a < !!!max 16mm

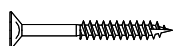
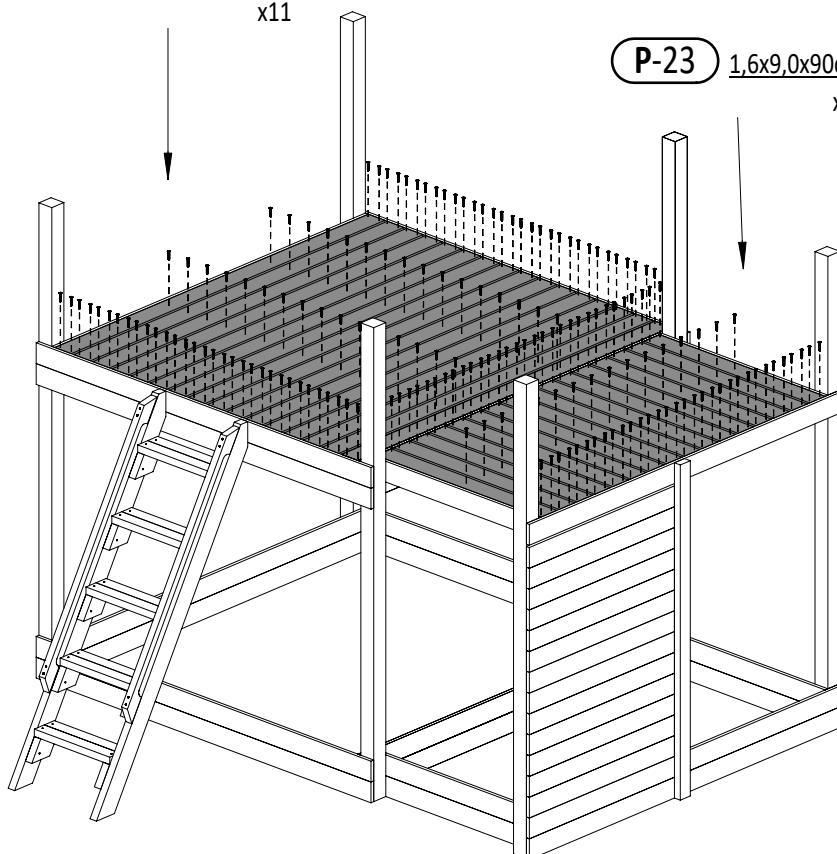

W40 x146

24

Zgodnie z normą PN-EN 71 stosuj zalecenia producenta odnośnie odległości oraz metody mocowania poszczególnych elementów

In compliance with the standard PN-EN 71, apply guidelines of the producer in relation to distances and methods of fastening individual elements

GX_SUNSHINE V2

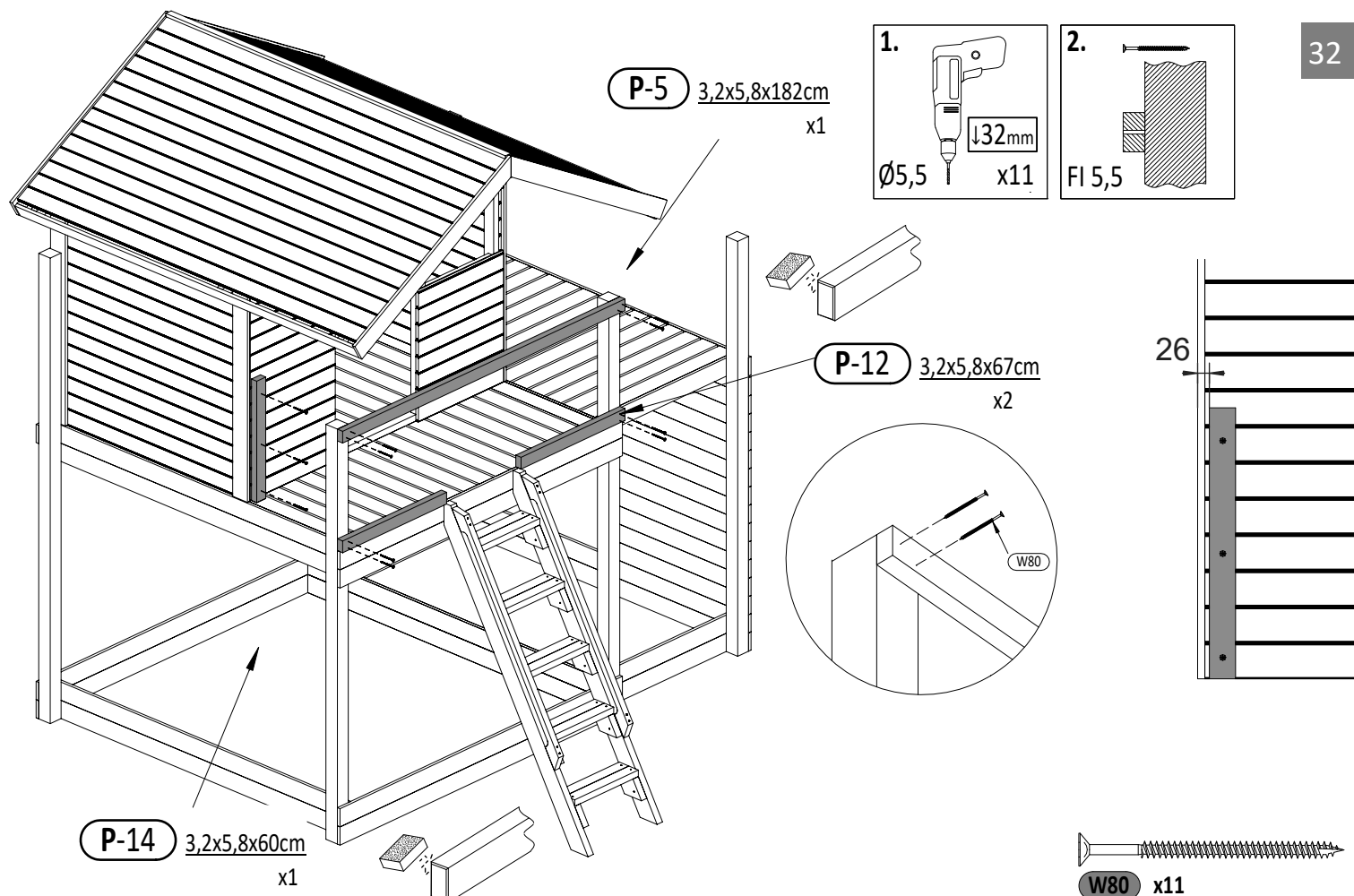
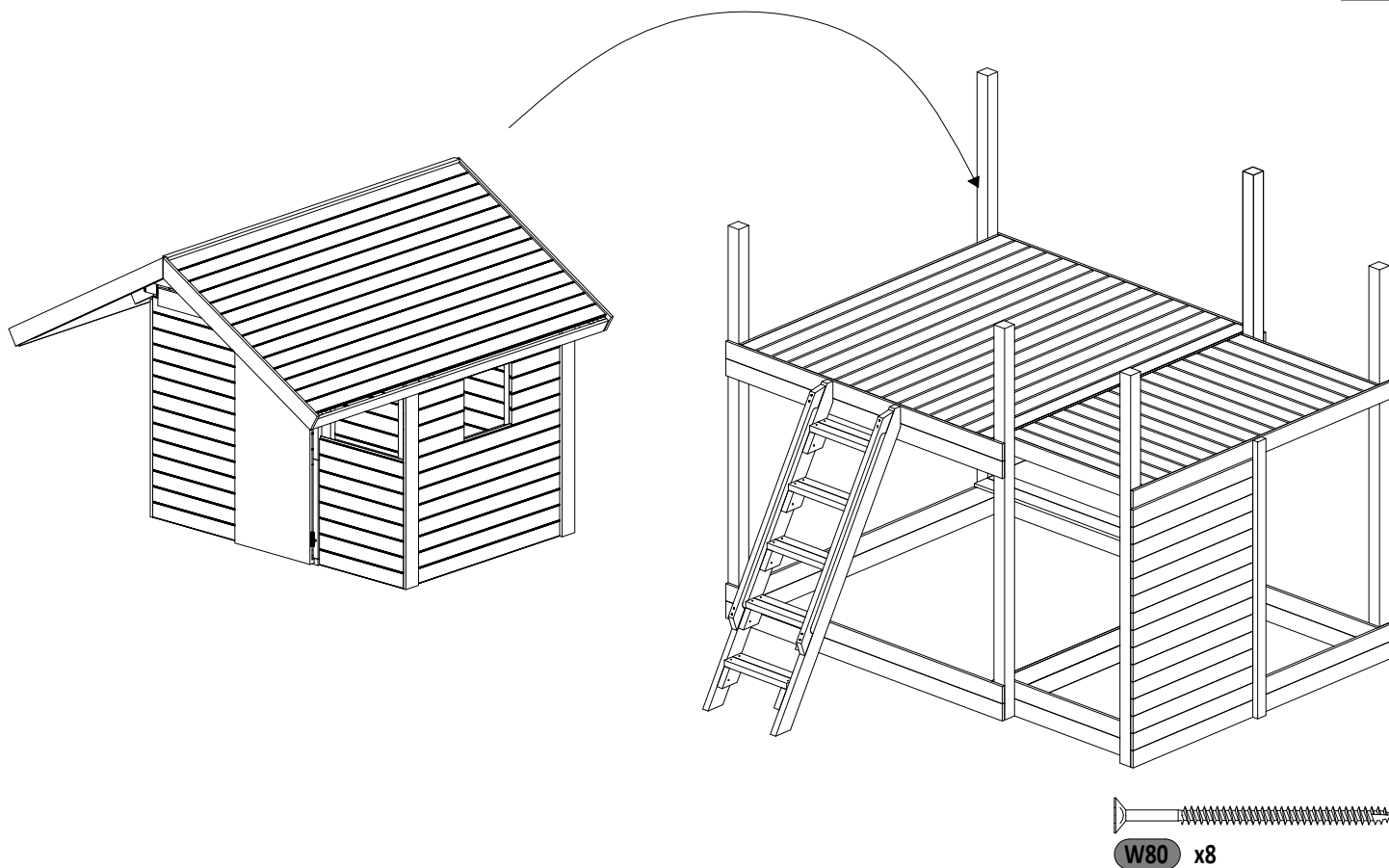

33

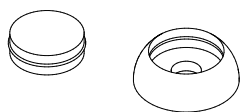
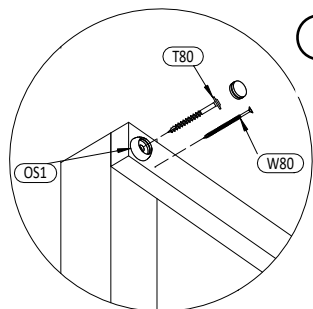
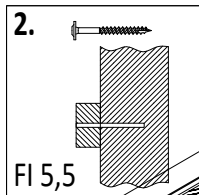
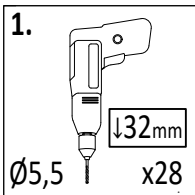

OS1 x28

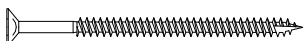

W80 x26

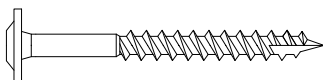

T80 x28

P-13 3,2x5,8x62cm
x2

P-11 3,2x5,8x90cm
x3

P-5 3,2x5,8x182cm
x1

P-10 3,2x5,8x98cm
x1

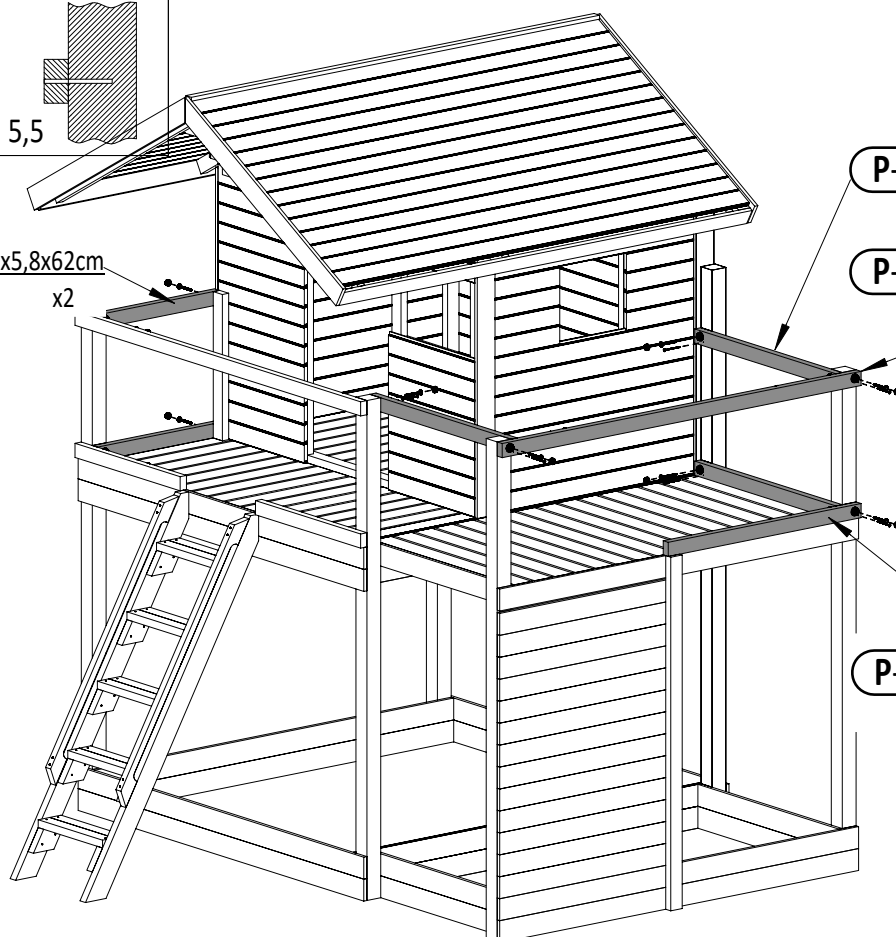

34

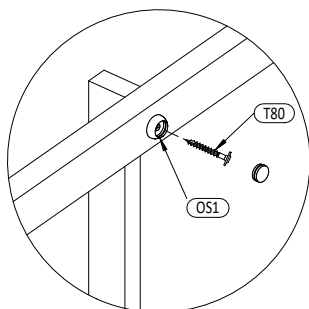
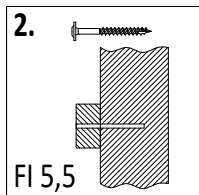
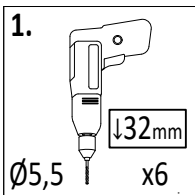

OS1 x6

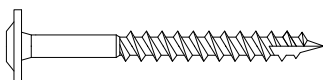

T80 x6

P-14 3,2x5,8x60cm
x3

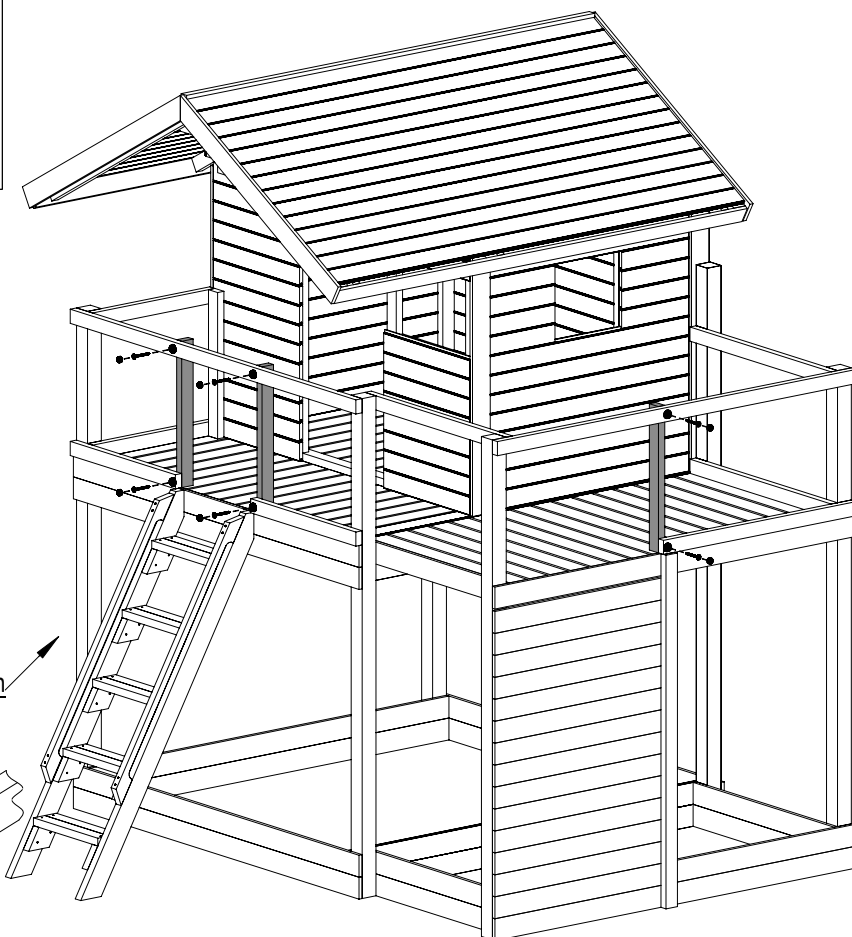
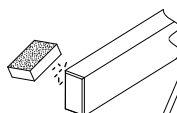

26

Zgodnie z normą PN-EN 71 stosuj zalecenia producenta odnośnie odległości oraz metody mocowania poszczególnych elementów
In compliance with the standard PN-EN 71, apply guidelines of the producer in relation to distances and methods of fastening individual elements

GX_SUNSHINE V2

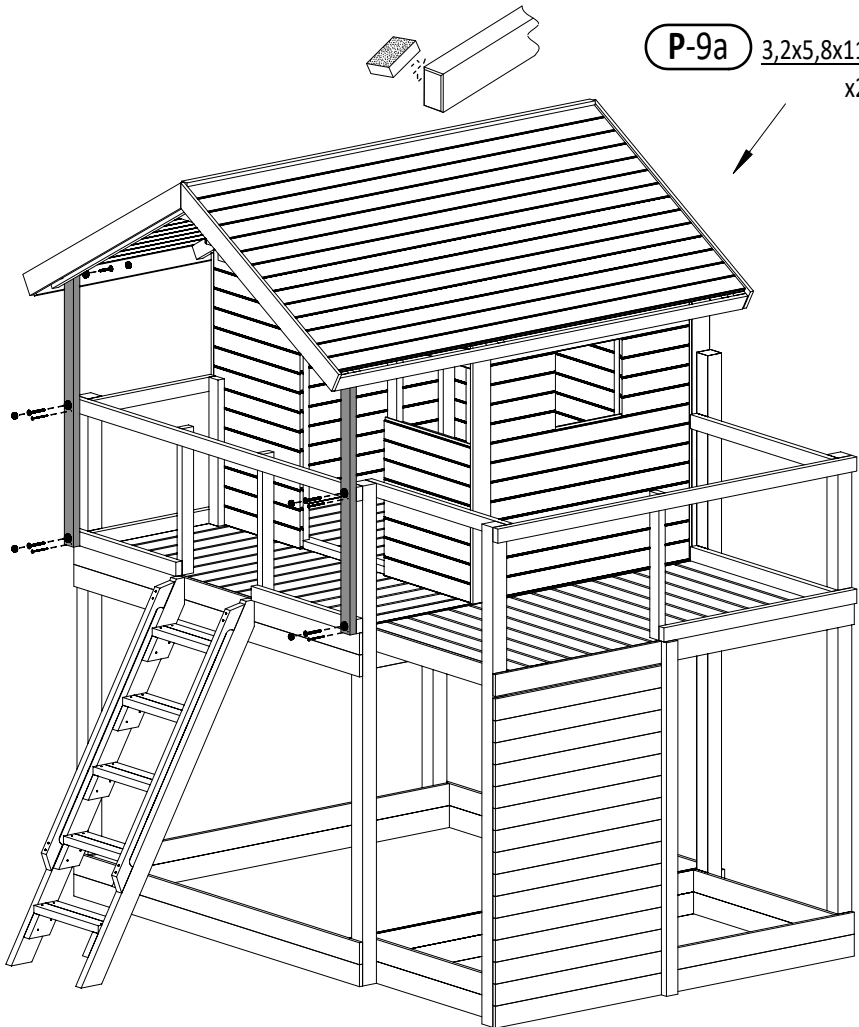

P-9a 3,2x5,8x116,8cm
x2

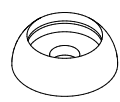
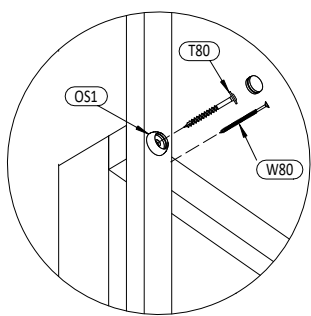
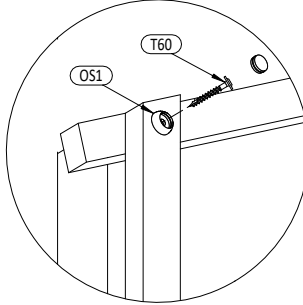
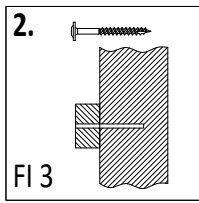
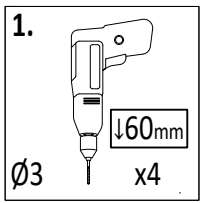

OS1 x6



W80 x4

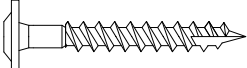

T60 x2

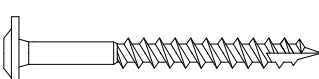

T80 x4

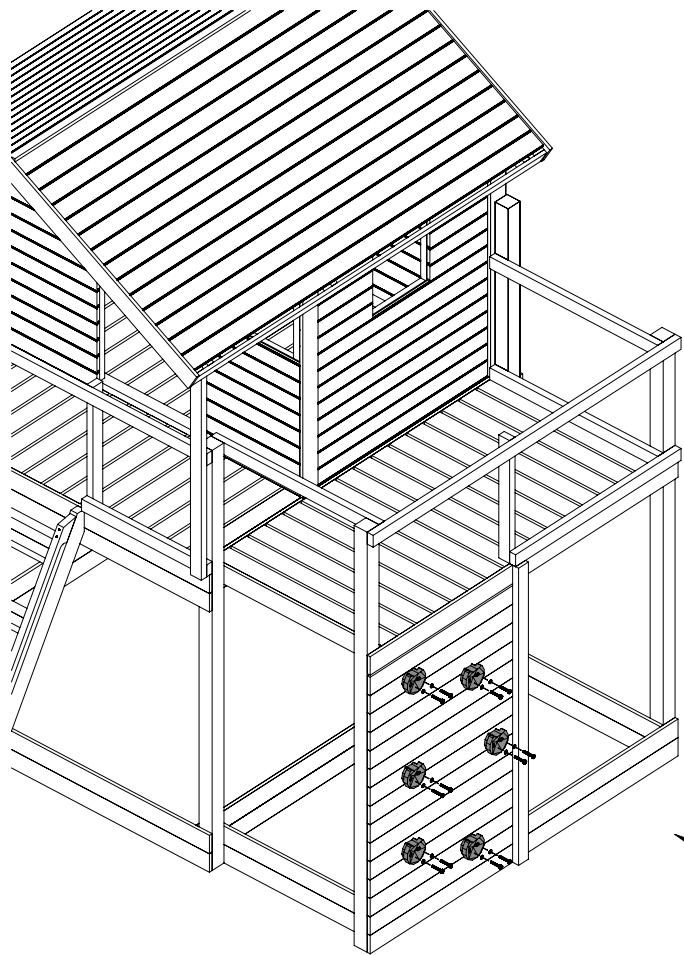

SW x6

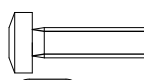
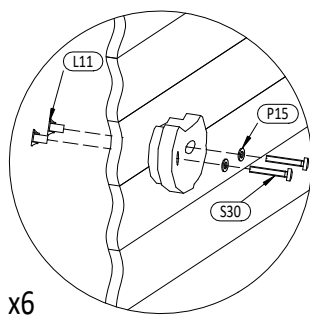
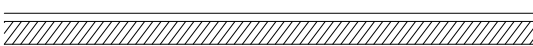
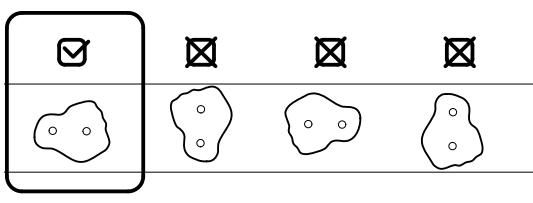
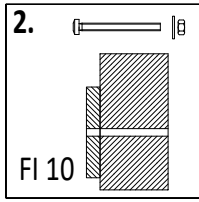
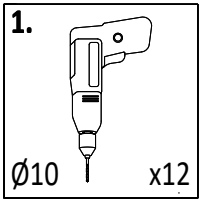

S30 x12



P15 x12

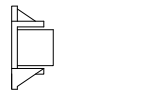

L11 x12

Zgodnie z normą PN-EN 71 stosuj zalecenia producenta odnośnie odległości oraz metody mocowania poszczególnych elementów
In compliance with the standard PN-EN 71, apply guidelines of the producer in relation to distances and methods of fastening individual elements

37

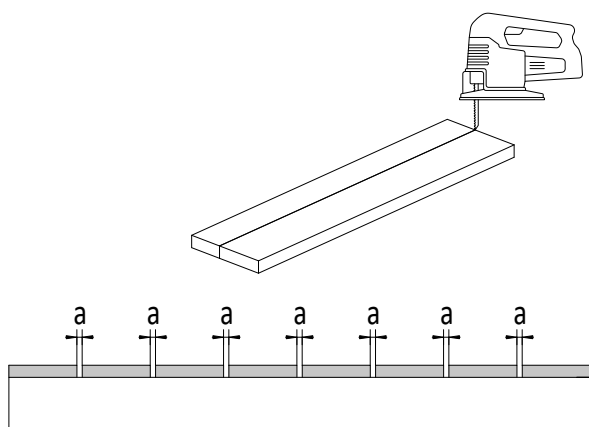
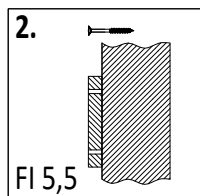
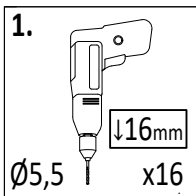

!!!min 2mm < a < !!!max 6mm

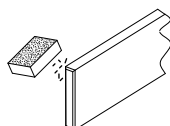
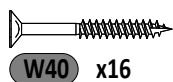

P-23 1,6x9,0x90cm
x4

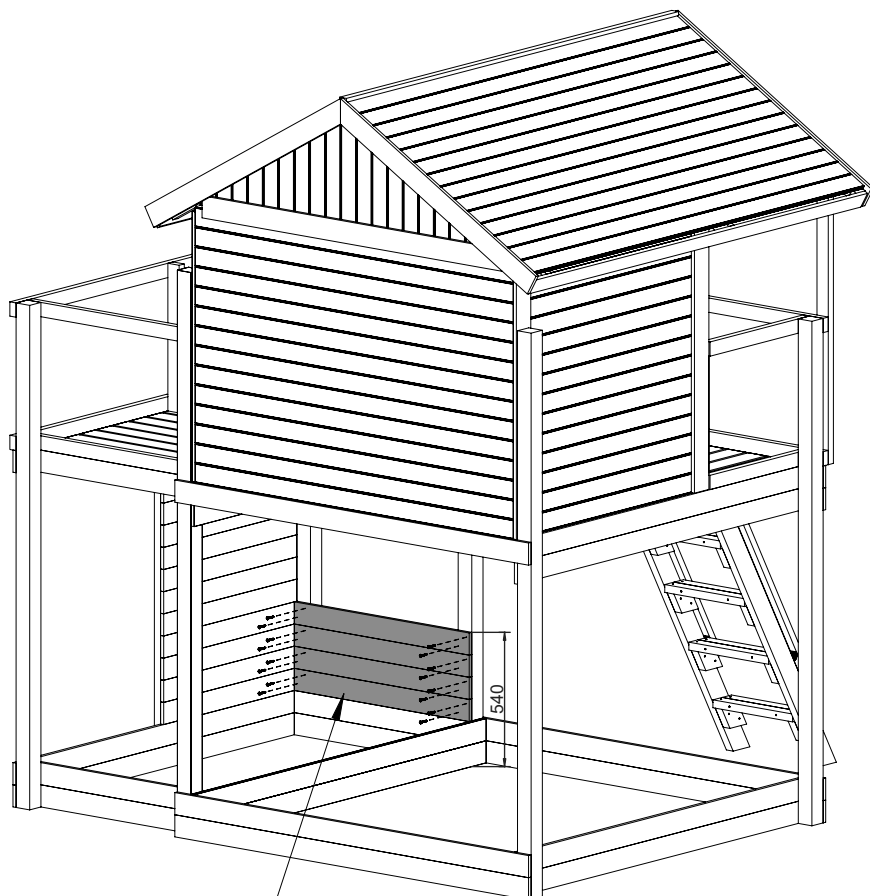

38

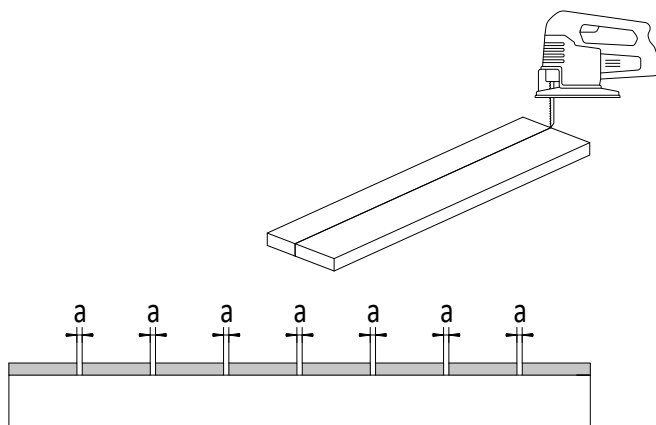
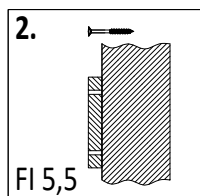
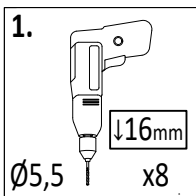

!!!min 2mm < a < !!!max 6mm

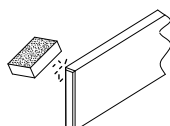
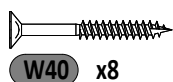

P-23 1,6x9,0x90cm
x4

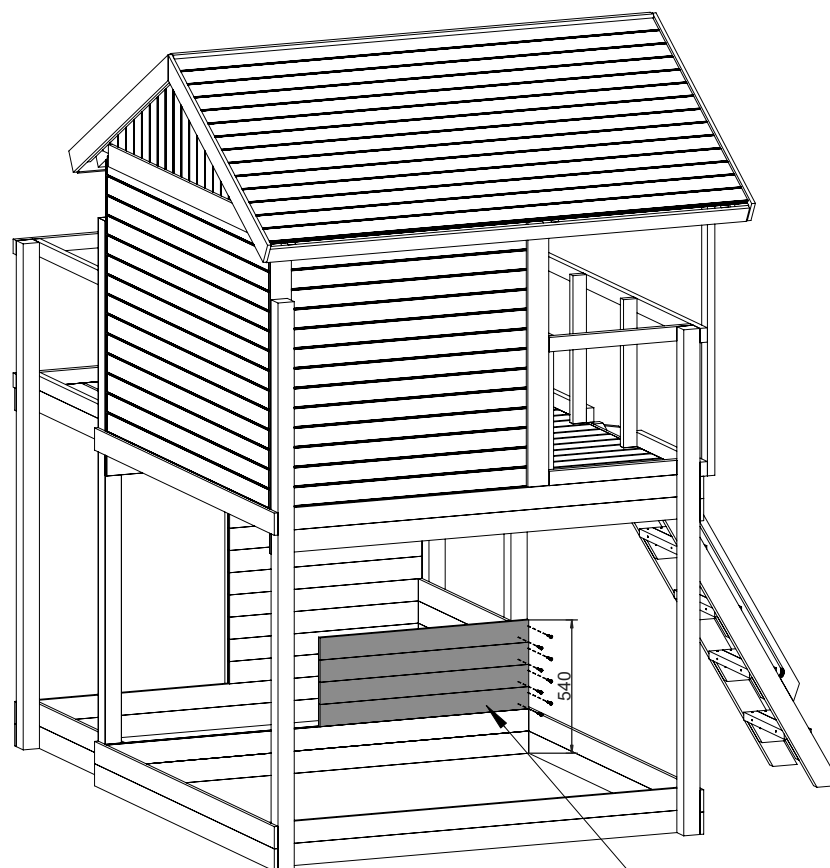

28

Zgodnie z normą PN-EN 71 stosuj zalecenia producenta odnośnie odległości oraz metody mocowania poszczególnych elementów

In compliance with the standard PN-EN 71, apply guidelines of the producer in relation to distances and methods of fastening individual elements

GX_SUNSHINE V2

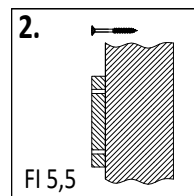
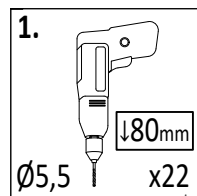
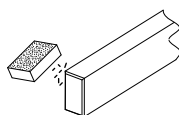

P-15 3,2x5,8x44cm
x2

P-18 3,2x5,8x33,5cm
x2

P-15 3,2x5,8x44cm
x2

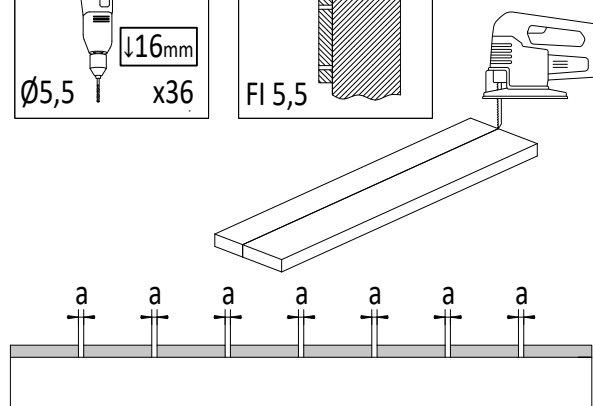
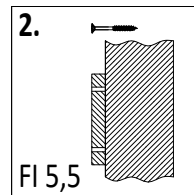
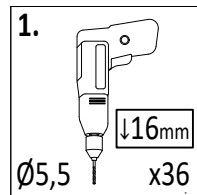
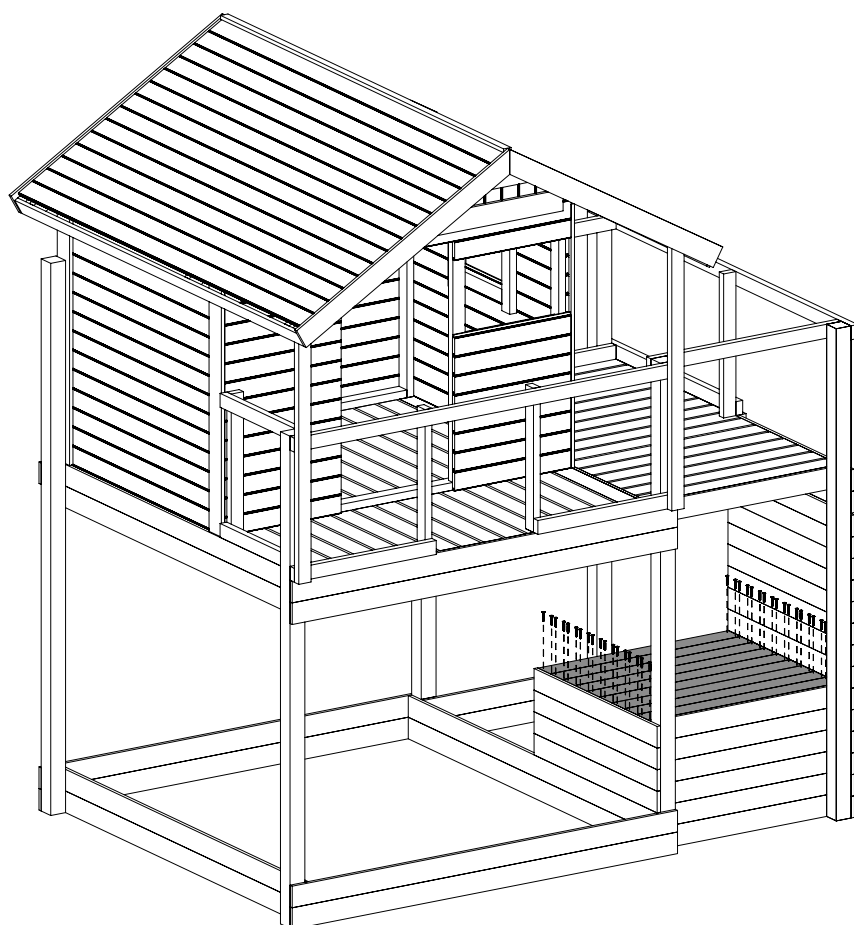
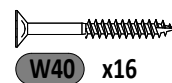
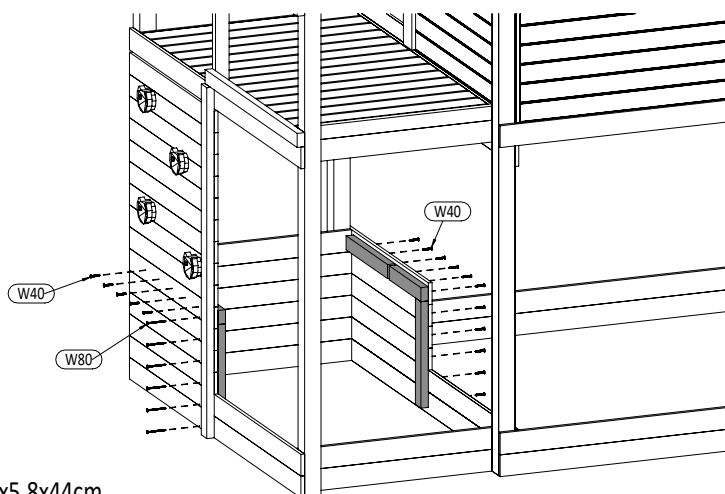
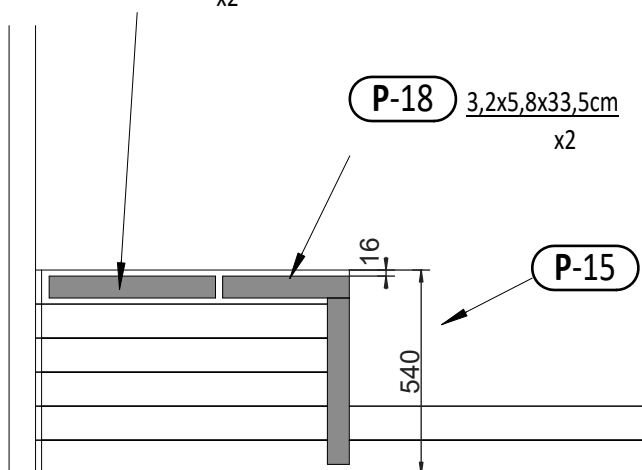

!!!min 2mm < a < !!!max 6mm

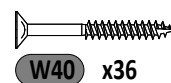
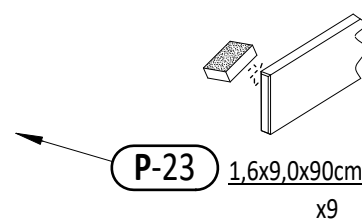

Zgodnie z normą PN-EN 71 stosuj zalecenia producenta odnośnie odległości oraz metody mocowania poszczególnych elementów

In compliance with the standard PN-EN 71, apply guidelines of the producer in relation to distances and methods of fastening individual elements

41

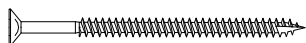
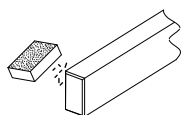
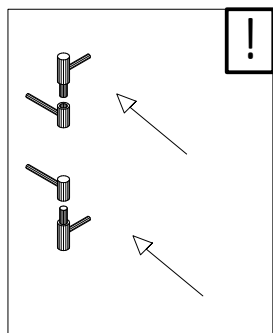

W80 x4

H-7a 3,2x5,8x54cm x1

H-5a 3,2x5,8x100cm x1

H-25a 3,0x49x105cm x1

H-8a 3,2x5,8x500cm x2

ZD x2

42

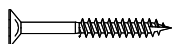
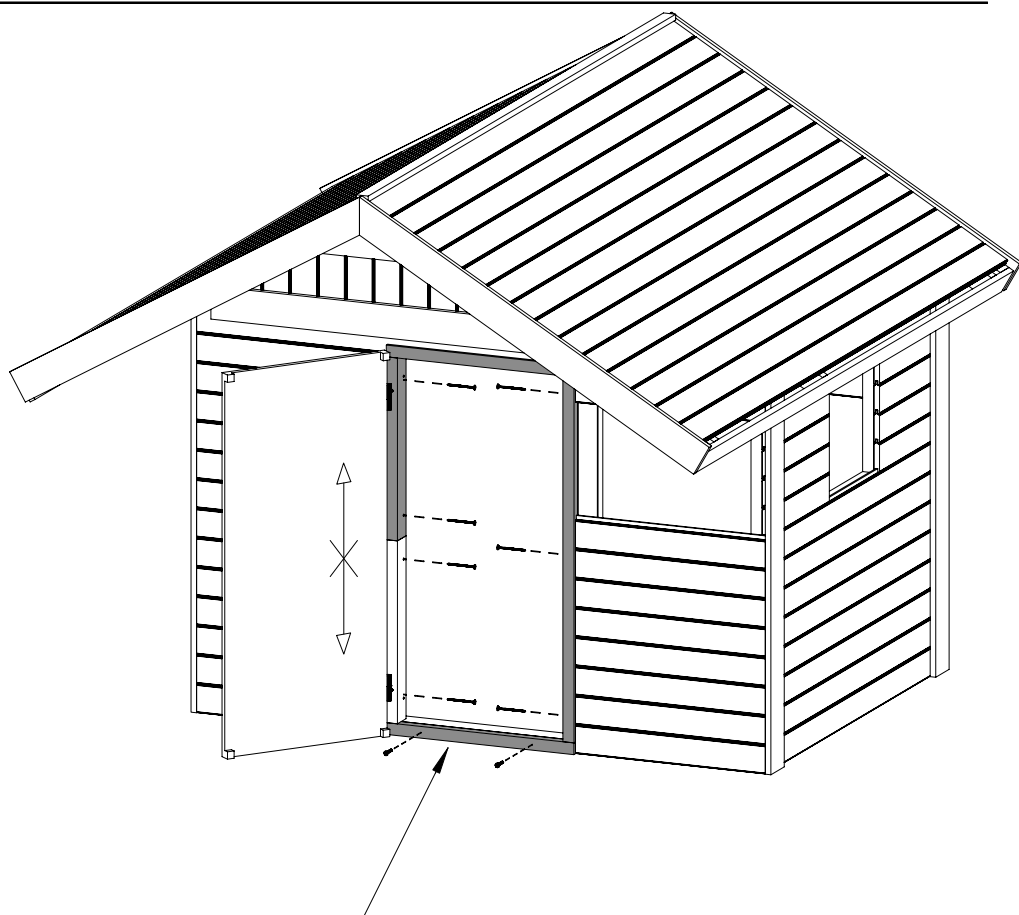

W40 x2



W80 x7

H-26 2,7x3,2x54cm x1

30

Zgodne z normą PN-EN 71 stosuj zalecenia producenta odnośnie odległości oraz metody mocowania poszczególnych elementów
In compliance with the standard PN-EN 71, apply guidelines of the producer in relation to distances and methods of fastening individual elements

GX_SUNSHINE V2

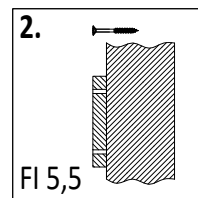
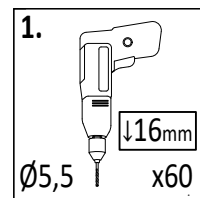
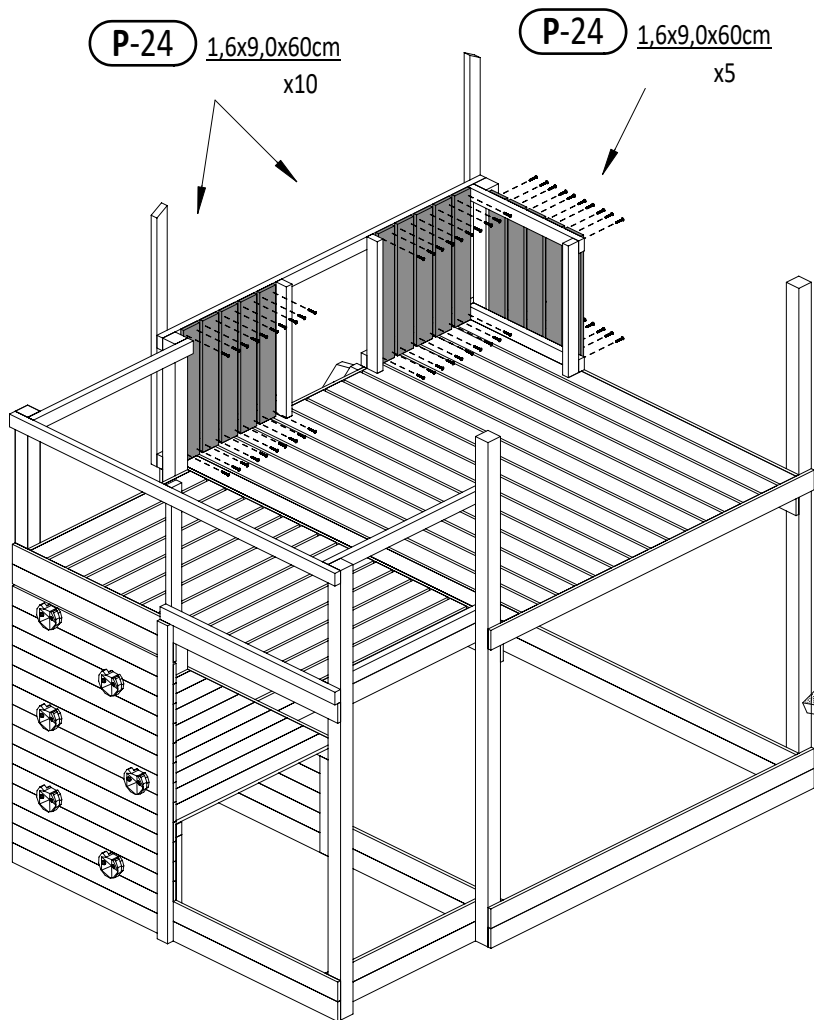

43

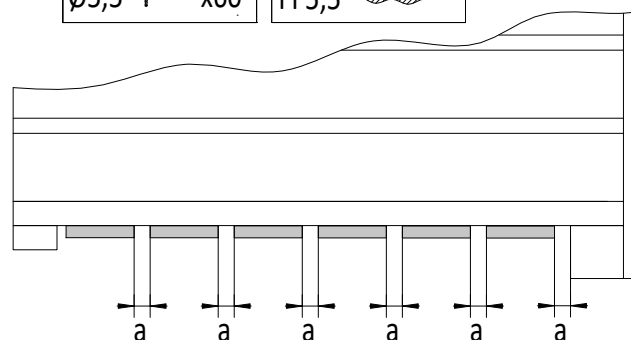

!!!min 13mm < a < !!!max 23mm

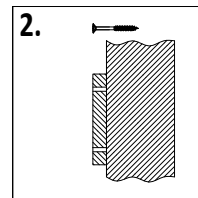
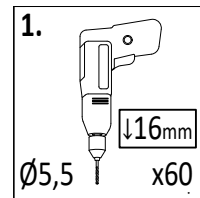
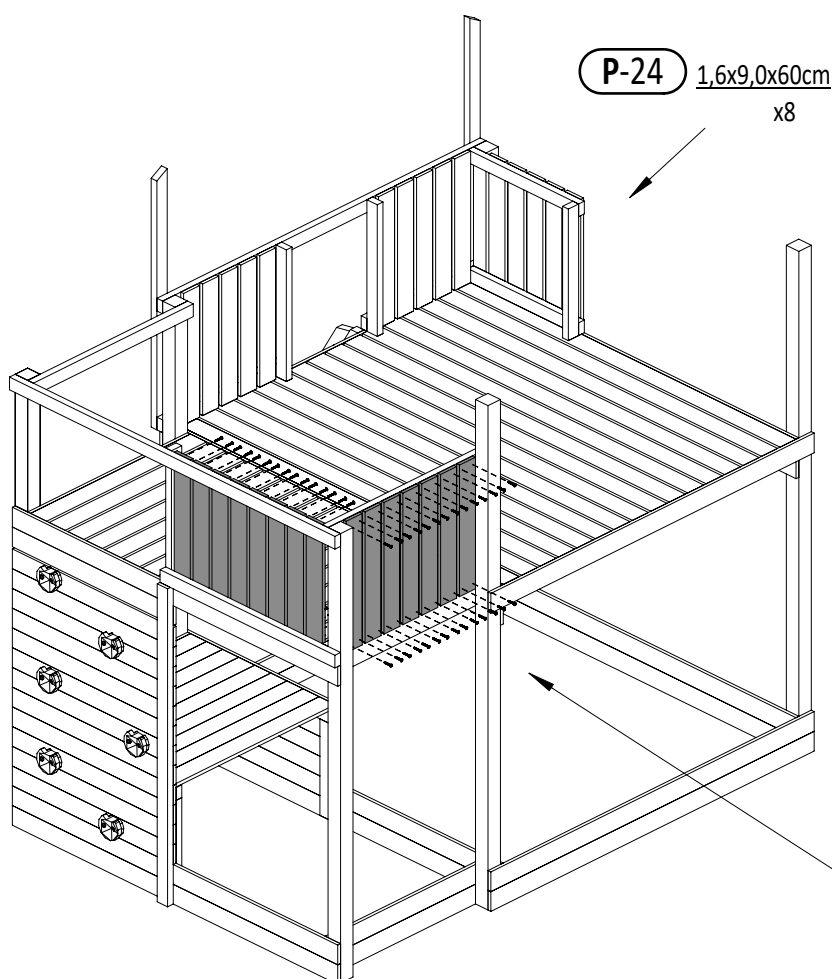
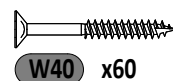

44

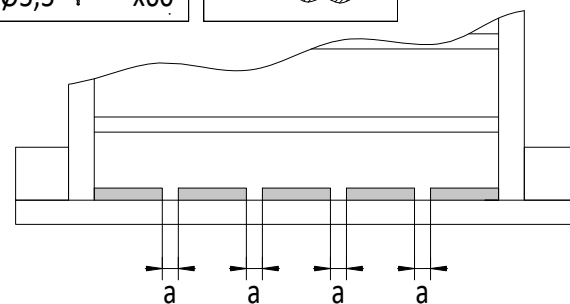

!!!min 13mm < a < !!!max 23mm

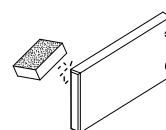

P-24 1,6x9,0x60cm x7

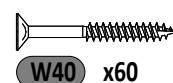

45

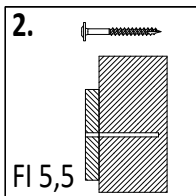
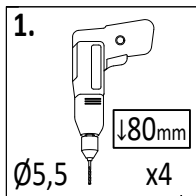

OS1 x4

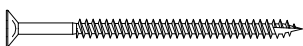

W80 x8

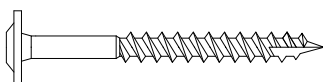

T80 x4

P-1b 7,0x7,0x230cm
x2

P-22a 1,6x9,0x120cm
x1

P-25a 1,6x9,0x32,5cm
x1

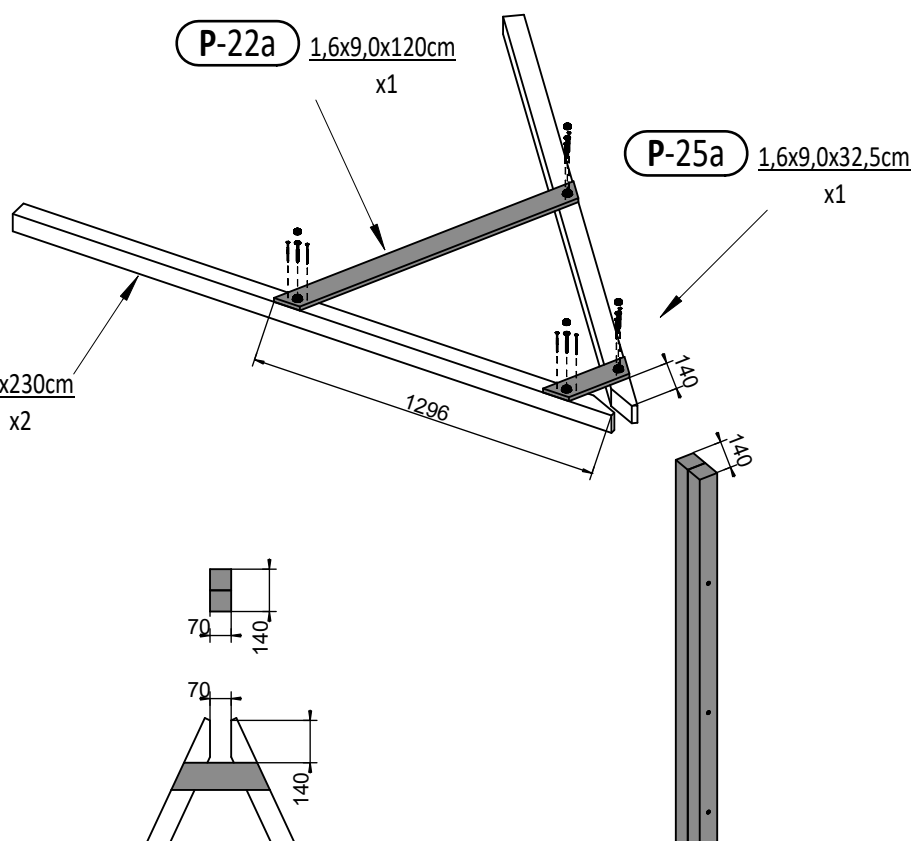

46

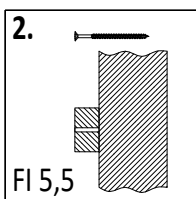
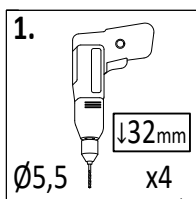
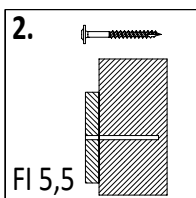
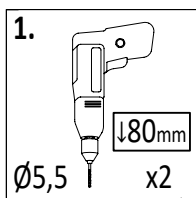

OS1 x2

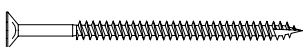

W80 x8

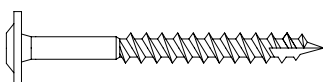

T80 x2

P-1a 7,0x7,0x230cm
x2

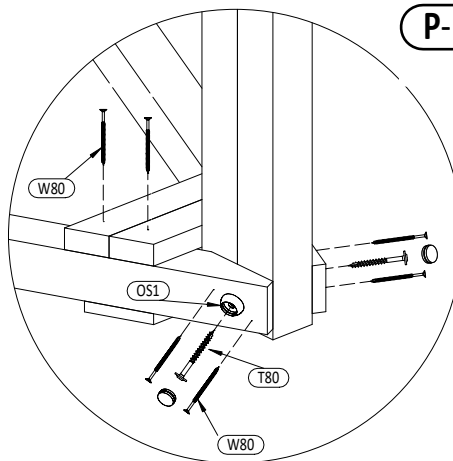

P-17a 3,2x5,8x35cm
x1

P-19a 3,2x5,8x29,6cm
x1

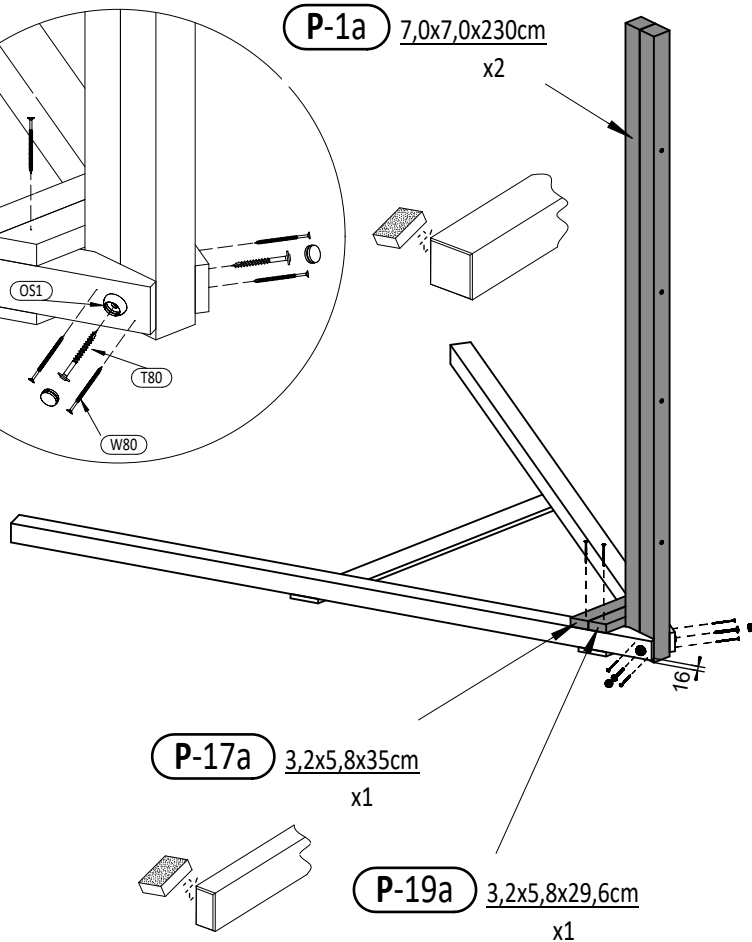

32

Zgodne z normą PN-EN 71 stosuj zalecenia producenta odnośnie odległości oraz metody mocowania poszczególnych elementów

In compliance with the standard PN-EN 71, apply guidelines of the producer in relation to distances and methods of fastening individual elements

GX_SUNSHINE V2

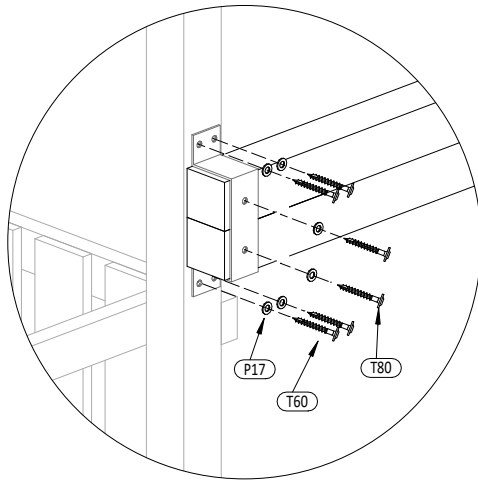
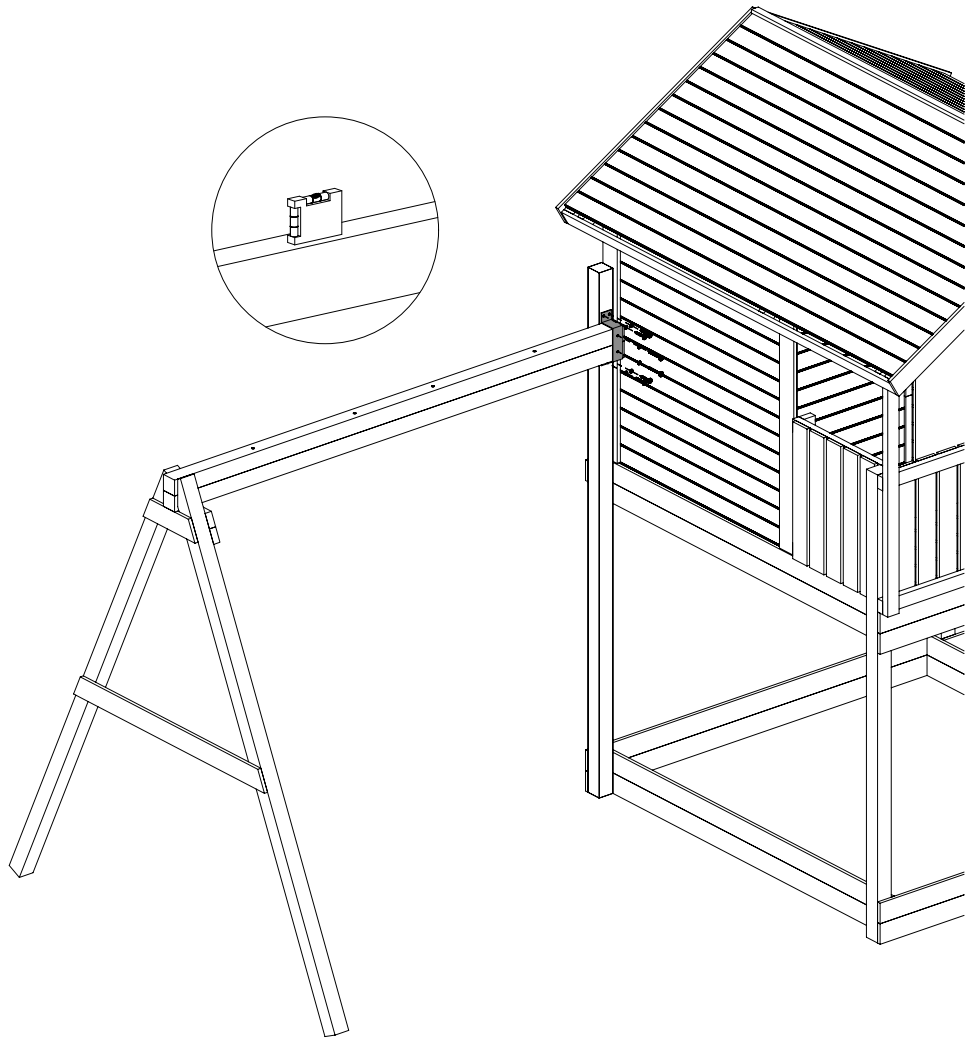

P17 x6

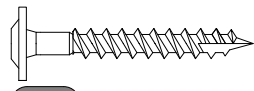

T60 x4

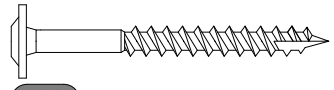

T80 x2

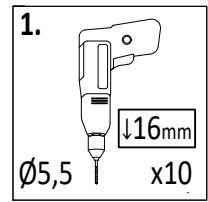
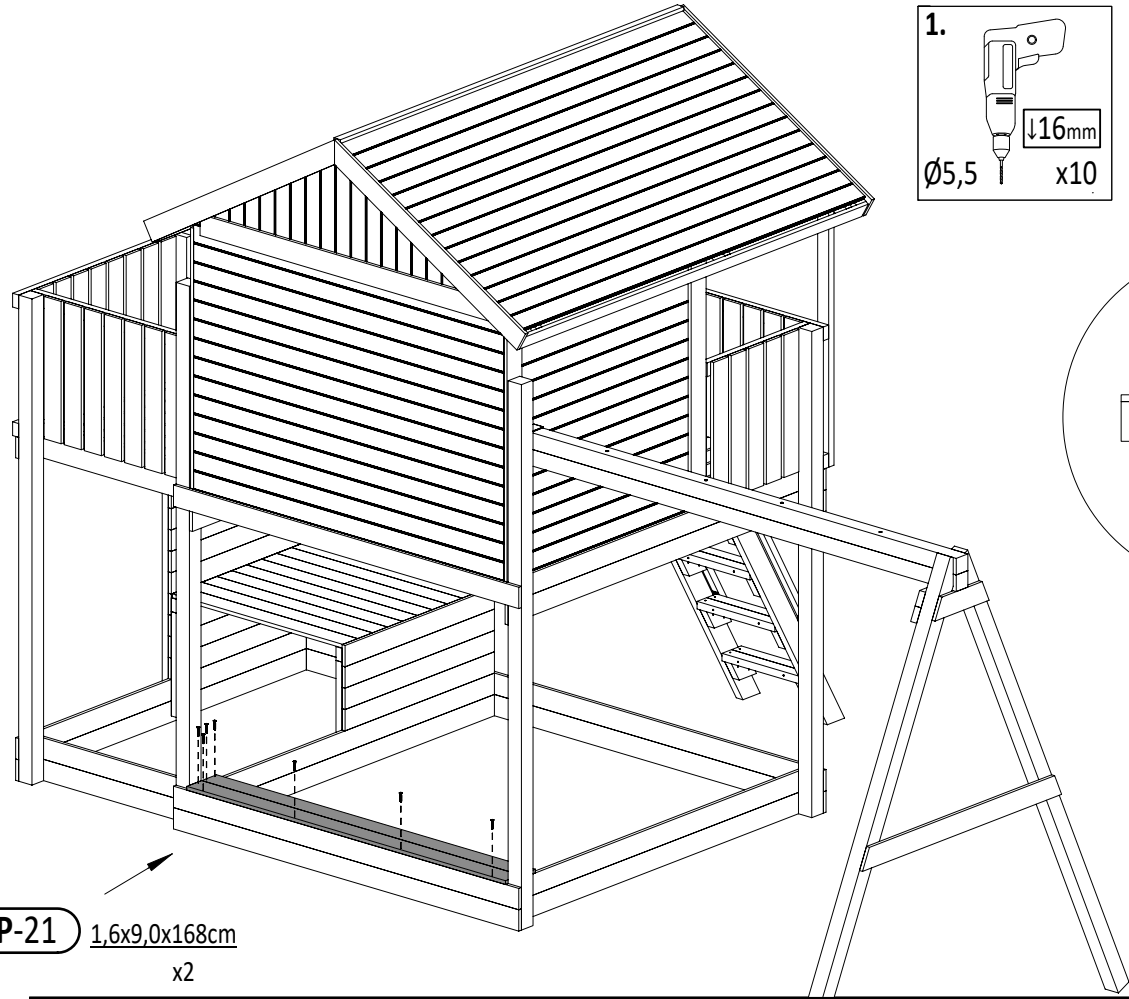

Ø5,5 x10

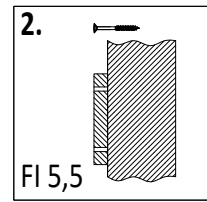

FI 5,5

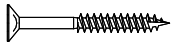
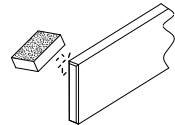
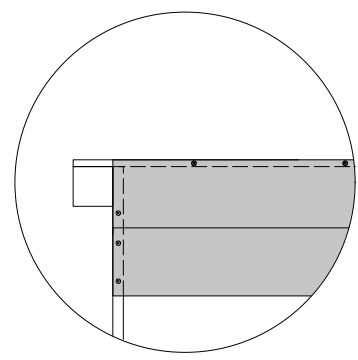

W40 x10

P-21 1,6x9,0x168cm
x2

Zgodne z normą PN-EN 71 stosuj zalecenia producenta odnośnie odległości oraz metody mocowania poszczególnych elementów
In compliance with the standard PN-EN 71, apply guidelines of the producer in relation to distances and methods of fastening individual elements

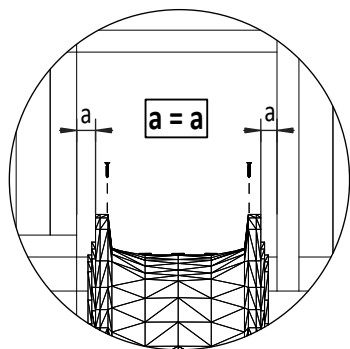

(Z) x1

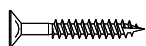

W30 x2

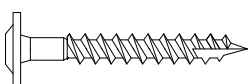
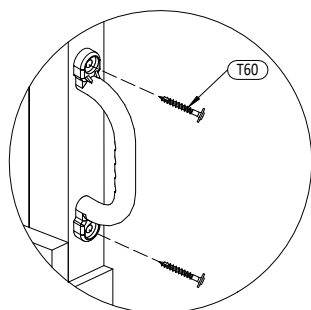
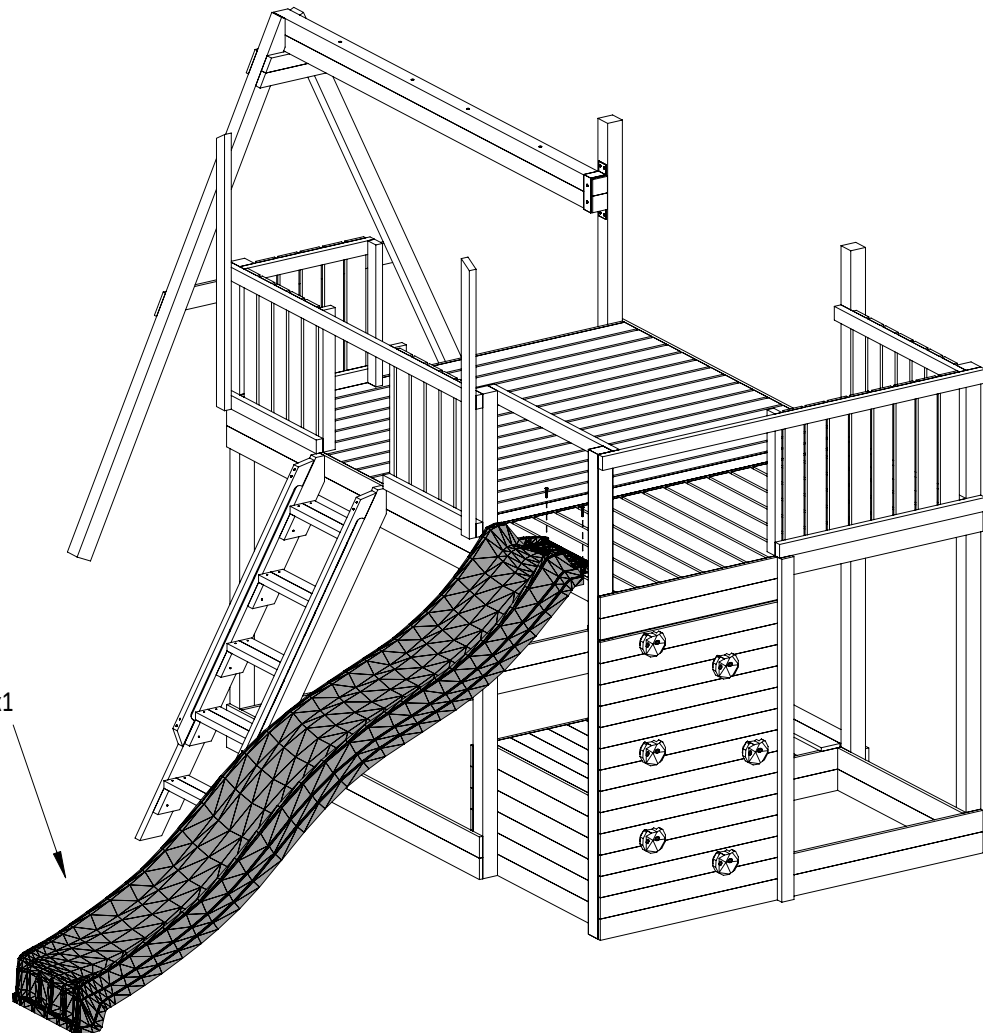

T60 x12

(UC) x6

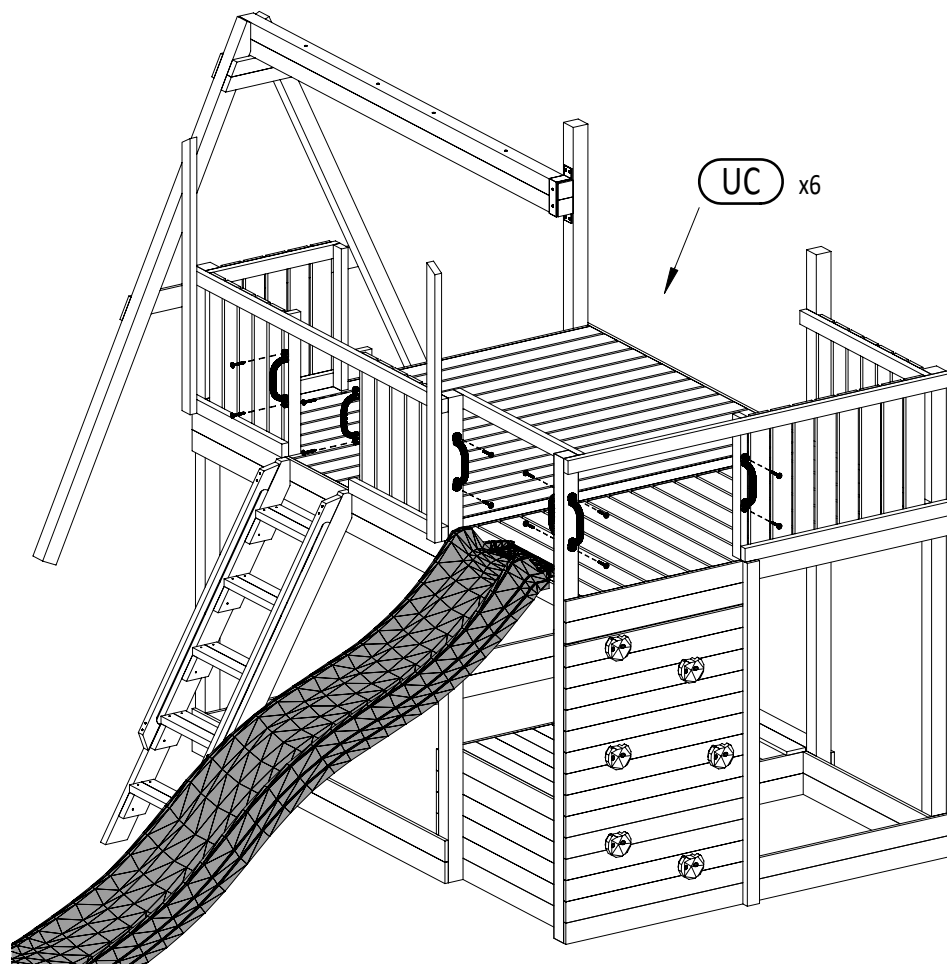

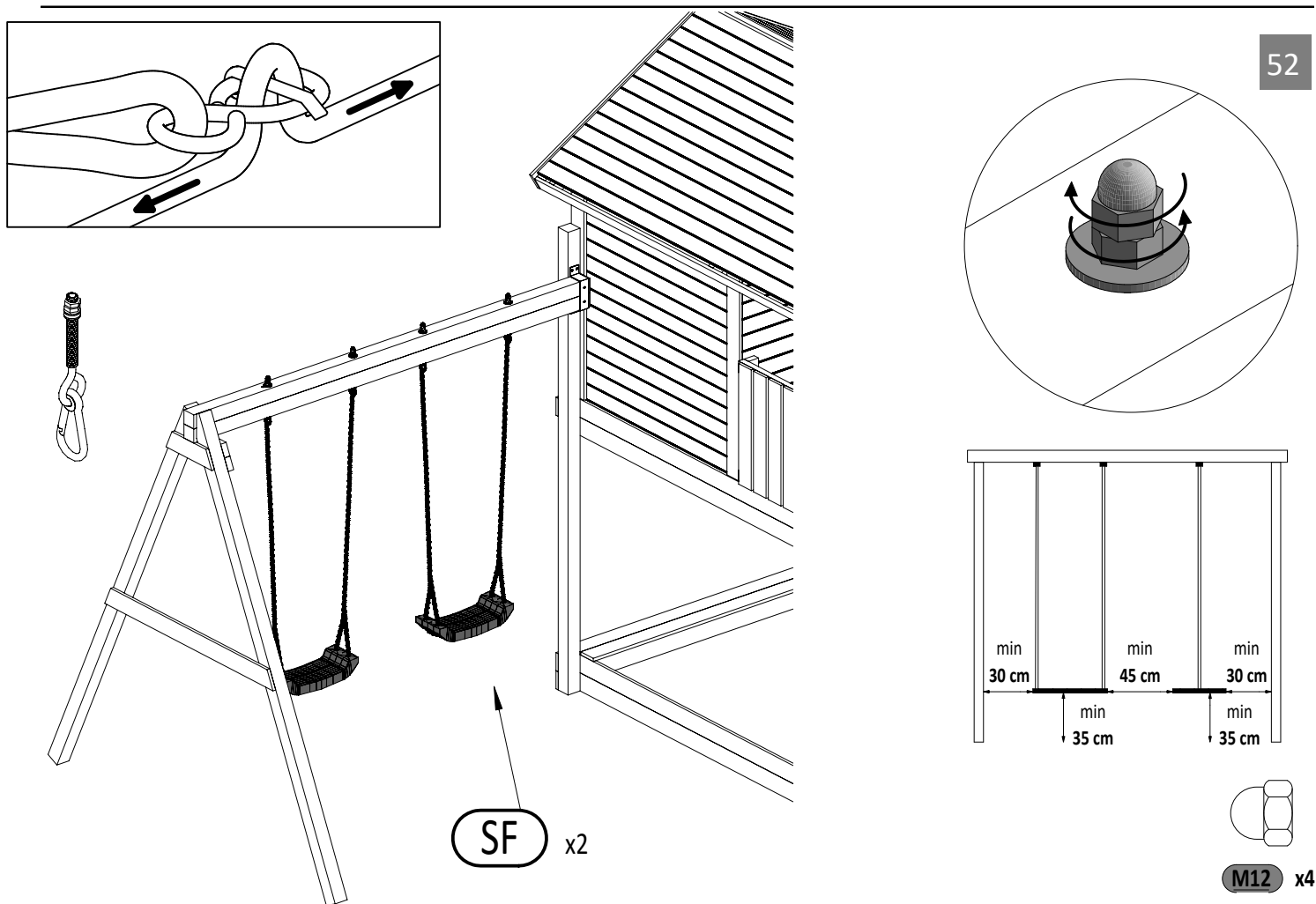
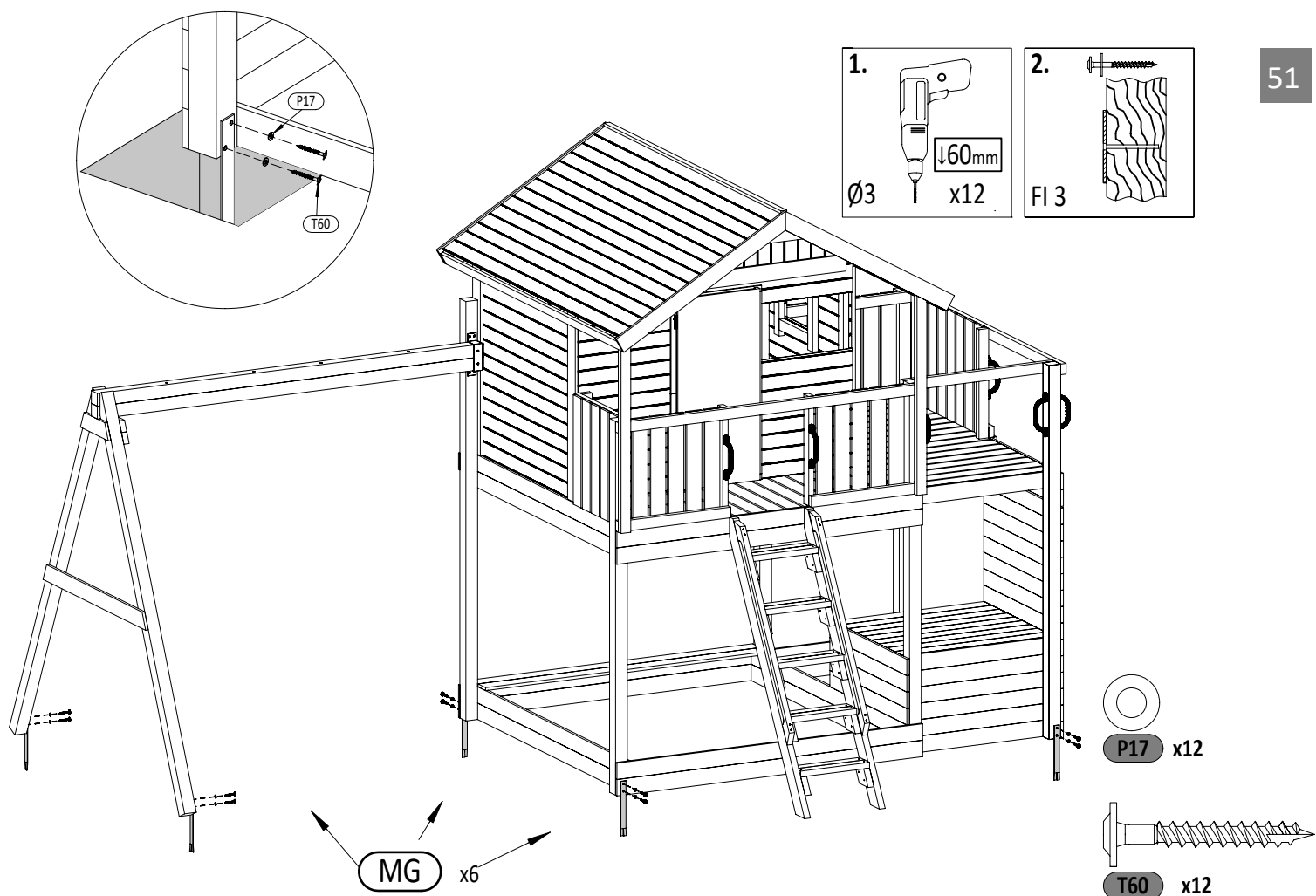

53

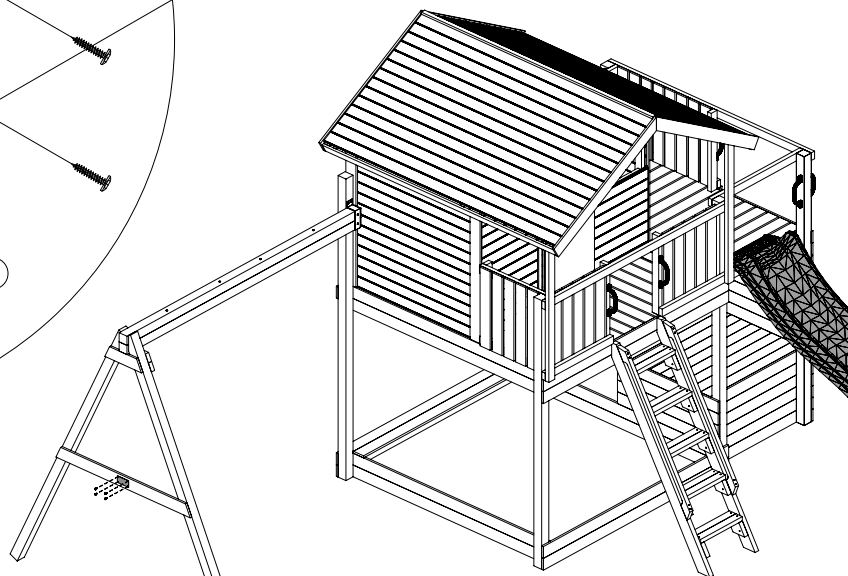
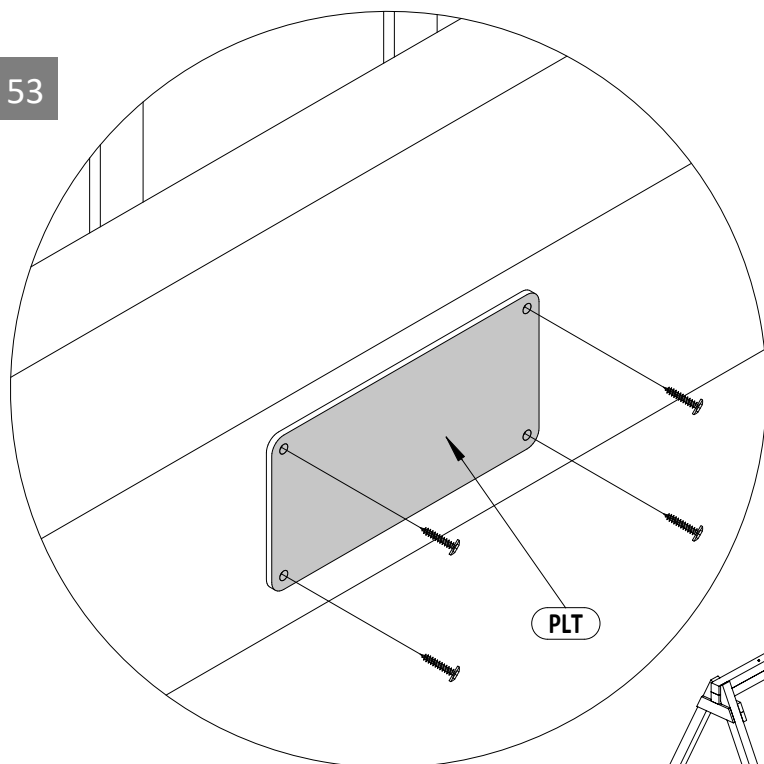

W20 x4

54

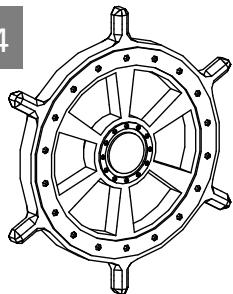

PW x1

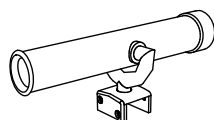

TS x1

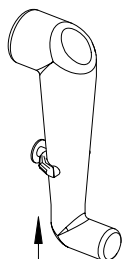

PS x1

